

# *The Salhouse* Saga



---

**Village Magazine and Newsletter**

---



---

**Spring 2023**

**Issue 118**

---

**New Patients Welcome**

## Are you looking for an affordable comprehensive private dentist?

Hoveton Dental Clinic welcomes new patients and can offer you and your family:

- A friendly and professional team
- A full range of routine dental treatments including cosmetic, dental implants and intravenous sedation
- Emergency appointments
- Different payment options
- Dental payment plans arranged by Denplan from **£9.85** per adult, per month

*Terms and conditions apply*

**HOVETON Dental Clinic**

CareQuality Commission
 dentistfinder
 invisalign®
 BACD British Academy of Cosmetic Dentistry ACCREDITED MEMBER
 BDA British Dental Association

**Call 01603 782885**  
to book your first appointment.  
We look forward to welcoming you.

thedentalcareclinic@hotmail.co.uk
 Dr. Haritha Penninti

19 Church Road | Hoveton | Norwich | Norfolk | NR12 8UG



## PURE Beauty

## A full Range of Beauty Treatments for Men & Women

Facials | Threading | Specialised Waxing | Fake Bake | Tanning  
Massage | Manicures | Pedicures | Bio-Sculpture Nails | Ex Flow Acrylic Nails

**Gift Vouchers Available | Free Parking**

**10% Off all treatments with this advert!**

Pure Beauty | 07706 542304 | Sprowston  
www.purebeautynorwich.co.uk | hello@purebeautynorwich.co.uk

**Front Cover picture:** Early spring daffodils at Shrubland Pond.

Photo: Editor

# Contents

## Local & Village Reports

Editorial .....	4
From the Parish Council .....	6
Salhouse United Charities .....	9
County/District Councillors Reports .....	10
North Rackheath Working Group .....	12
Wroxham and Hoveton Surgery .....	14
Police Beat Manager .....	16
From the Rectory .....	20
Wroxham and Rackheath WI .....	23
Salhouse Baptist Chapel .....	27
Wroxham Library .....	32
Salhouse Pubs Update .....	34
Wroxham Flower Club .....	35
Salhouse Bell Reading Group .....	36
Team Salhouse .....	43
Salhouse Station Group .....	44
Friends of Salhouse School .....	45
Salhouse Broad Ranger .....	48
Wroxham and Hoveton Lions .....	54
1st Salhouse Beavers and Cubs .....	56
2nd Salhouse Brownies .....	58
Rainbows .....	59
1st Salhouse Scouts .....	60
Jubilee Hall Committee .....	65
Salhouse Rovers FC .....	66
Salhouse Tree Steward .....	68
Afternoon Tea and Mardle .....	69
Salhouse and District Gardening Club .....	70

## Information

Village Information .....	2-3
Parish Councillors/Meetings .....	8-9
Services in the Bittern Benefice .....	21
Find a Planning Application .....	38
Open Gardens for St,John Ambulance ..	55
Defibrillators - Locations & Instructions ..	76
Useful Contacts List .....	79
Advertisers Index .....	80

## Articles and Features

Editorial .....	4
Kev's Brainbuster Quiz .....	5
Coronation Event Announcement .....	26
Grow Your Own Vegetables .....	46
Property Report .....	72
Quiz Answers .....	77

# Salhouse Saga

is published three times per year. It is delivered free to all households in the Parish of Salhouse, and is produced entirely by volunteers, including editorial, publication and distribution. Printing is covered by the advertising revenue, and any surplus donated to local causes. An online version is also available at:

[www.salhousepc.info/services&amenities](http://www.salhousepc.info/services&amenities)

Printed by HD Print of Ware, Herts

**PLEASE SUPPORT OUR  
ADVERTISERS, BECAUSE THEY  
SUPPORT US!!**

## Advertise your business locally in the Salhouse SAGA

If you would like to advertise your business in the magazine please contact  
Richard Flatters

Telephone: 0755 22 33 527

[flatters798@btinternet.com](mailto:flatters798@btinternet.com)

Advertising Rate per single issue:

**Full Page: £35 b&w / £55 colour**

**Half Page: £20 b&w / £30 colour**

**Quarter Page: £10 bw / £15 colour**

**Editor: Colin McCormick**  
Telephone: (01603) 721229  
E-mail: [colinmccormick@talk21.com](mailto:colinmccormick@talk21.com)

**Advertising: Richard Flatters**  
Telephone: 0755 22 33 527  
E-mail: [flatters798@btinternet.com](mailto:flatters798@btinternet.com)

**Distribution: Pauline Garner**  
Telephone: (01603) 721201  
E-mail: [pauline@mps29.plus.com](mailto:pauline@mps29.plus.com)

## Next Edition of the SAGA

An early reminder that the next edition of the Salhouse

Saga will be in July 2023.

**Copy deadline Friday July 7th .**

*Editor's views are not necessarily those of the contributors. E&OE*

## SALHOUSE CLUBS & GROUPS



*At the Jubilee Hall unless otherwise specified*

**Guides (1st Salhouse)**  
Monday 6.30 -8.00 pm

**Brownies (1st Salhouse)**  
Tuesday 5.30 - 7.00 pm  
Contact: - Mrs S Shorten:  
01603 720450

**Brownies (2nd Salhouse)**  
Tuesday 3.30 - 5.00 pm  
Contact: - Natalie Archer:  
01603 927166  
2ndsalhousebrownies@  
mail.com

**Rainbows**  
Tuesdays 3.45pm

**Cubs**  
Wednesday 6.00 - 7.30pm  
Contact: - Jackie Rose:  
01603 712520

**Beavers**  
Wednesday 4.45 - 5.45pm  
Contact: - Jackie Rose:  
01603 712520

**Scouts**  
Thursday 7.00 —9.00pm  
Contact: - Simon Hill  
Salhousescouttrou  
p@gmail.com

**Ping Pong (table tennis)**  
Tuesdays 10am—12.00  
£2.00 Incl. refreshments  
Contact - David / Margaret  
Loveday:  
01603 781768  
4.haling@gmail.com

**Broadland Youth Choir**  
Friday 4.30 - 6.0 pm  
Monday (except 2nd  
Monday in month)  
7.45-9.00pm  
Contact: - Mrs C. Tims:  
01603 721912

**Gardening Club**  
3rd Tuesday of the month  
7.30pm at Woodbastwick  
Village Hall  
Nick Taylor :  
01603 720165

**Tea and Mardle**  
2nd Weds of the month  
2.00—4.00pm  
Julie Redburn  
01603 720049

**Salhouse Bell Reading Group**  
1st Thurs of the month at  
7.30pm at Heathlands  
Social Club, Blofield  
Heath (until further notice)  
Julie Redburn  
01603 720049

**Soulful Yoga**  
Fridays 10—11 am  
07900 212441  
iamsoulfullyoga@gmail.com

**Doctors Surgery**  
The Surgery at the Village  
Hall has been suspended  
indefinitely

DATES, TIMES AND  
CONTACT DETAILS ARE  
CORRECT TO THE BEST  
OF OUR KNOWLEDGE.

PLEASE DO NOT ATTEND  
ANY EVENT WITHOUT  
CHECKING WITH THE  
ORGANISER

ANY CHANGES PLEASE  
INFORM THE EDITOR SO  
THAT INFORMATION CAN  
BE UPDATED



## VILLAGE CONTACT NUMBERS

**Hoveton & Wroxham  
Medical Centre**  
01603 782155  
Out of Hours—111

**All Saints Church  
Rector  
Darleen Plattin**  
01603 720966  
darleenplattin@btinternet.com

**Church Warden  
James Watts**  
07814 292579  
payne2174@yahoo.co.uk

**Salhouse VC Primary School**  
Headteacher: Mrs J Church:  
01603 720402

**Friends of Salhouse School  
(FOSS)**  
Contact: Jodie Wardle / Jenny  
Cushing: foss2019@yahoo.com  
07709317186

**Salhouse Broad**  
Ranger: Kelly Banthorpe:  
01603 722775  
theranger@salhousebroad.org.uk

**Jubilee Hall (Management)**  
Martin Carney: 07808 097924



## MOBILE LIBRARY SERVICE

*The Mobile Library visits  
Salhouse on Tuesdays  
every 4 weeks at the  
following locations and  
times*

**3.55/4.15** Cheyney Ave,  
outside 81

**4.20/4.40** Farman Close, No2



**Parish Council**

**Parish Clerk**  
**Sarah Martin**  
Spinners Cottage  
18a Honing Row,  
Worstead,  
Norfolk NR28 9RH  
Tel: 01692 535775  
clerk.salhousepc@gmail.com  
website:www.salhousepc.info

**District Councillors**

**Martin Murrell:**  
07958 393059  
cllr.martin.murrell@broadland.gov.uk  
**Fran Whymark:**  
07907163123  
cllr.fran.whymark@broadland.gov.uk

**County Councillor**

**Fran Whymark:**  
07907163123  
fran.whymark.clllr@norfolk.gov.uk



**Mobile Post Office**

Jubilee Hall Car Park  
Wednesdays 12.30—1.30pm

**The Bell Inn:**  
01603 720220

**The Lodge Inn and Hotel:**  
01603 782828

**Salhouse Garden Centre:**  
01603 722250

**Black Barn Farm**  
07803 500610



**POLICE**

**EMERGENCY 999**  
**NON EMERGENCY 101**  
Ask for  
**PC 855 Al Jennings**  
**BEAT MANAGER**  
**Thorpe St Andrew**  
**Safer Neighbourhoods**  
**Team**  
**Norfolk Police H.Q.:**  
01953 424242

**NHS**  
**EMERGENCY 999**  
**NON EMERGENCY 111**  
N & N Hospital  
01603 286286

**GAS ESCAPE**  
Ring Freephone  
**0800 111 999**

**WATER OR SEWAGE**  
Call Anglia Water on  
**08457 145 145**

**FLOOD REPORTING**  
[www.Norfolk.gov.uk/  
safety/floods/report-a-  
flood](http://www.Norfolk.gov.uk/safety/floods/report-a-flood)

**ELECTRICITY**  
Call 24 hours a day on  
**105 or 0800 31 63 105**



**Recreation Ground,**  
**Thieves Lane, Salhouse**  
**Contact: - CHAIRMAN**  
Jim Blyth: 07788125888



*Events take place at the  
Jubilee Hall unless otherwise  
specified*

**Black Barn Farm**  
**Norwich Road**  
**Farmers' Market**  
Second Saturday of  
every month

**Salhouse Coronation  
Celebration Party and  
Picnic**  
Recreation Ground,  
Thieves Lane  
Sunday 7th May 12.00

**JUBILEE HALL  
BOOKINGS**  
Contact : Pat Barnes  
**01603 720466**  
Bookings taken  
Mon - Fri: 9am - 6pm  
Sat: 9am - 12noon

**PARISH NOTICE  
BOARDS**  
Right hand section is  
open to public to post  
notices (A5 size  
preferred)  
Left hand section for  
Parish Council  
notices only

# From the Editor

## Dear Readers,

Welcome to the Spring 2023 issue of Salhouse Saga.

We've got a very full magazine again this issue. Plans are being made for a Coronation Celebration event at the Recreation Ground on May 7th. This is still in the early stages, see page 26. There is also exciting news about the proposed new Medical Centre in Rackheath, see page 15.

A period of change: the few months since the last issue of SAGA have seen a number of changes in and around Salhouse, particularly in the field of retail activities. The much loved café and craft shop, Prima Rosa, who only late last year won a Good Food award, sadly closed its doors for the last time in December after seven successful years. The owners quoted approaching retirement age plus the inevitable energy costs as the reasons for calling it a day. On the positive side, the newly established Black Barn Farm, with its range of farm related retail businesses, on Norwich Road, was recently listed in the EDP as hosting one of the best Farmers' Markets in Norfolk. Congratulations to them.

Two very 'public' closures in December saw both Salhouse's pubs closed over Christmas, but both are set to re-open in the Spring under new ownership and management. They each intend to present a slightly different 'offer' so hopefully Salhouse will be blessed with two successful pubs in the village, (see the update report on page 34). At a time when pubs are closing everywhere, we are very lucky to have the prospect of two.

Sadly, the Salhouse Baptist Chapel in Chapel Loke has closed. The reason for this is simply a decline in numbers attending over the last two years, attributed in part to the advancing age of many of its members. The chapel first opened in 1802 and has had many ups and downs since then, including closures and loss of congregation, so maybe it will re-open again at some time in the future. We wish Simon and Jane success in their next venture and thank them for their contribution to life in Salhouse.

**Colin McCormick Editor**

# KEV'S BRAIN BUSTER—THE SAGA QUIZ



WHAT DO THE FOLLOWING BRAIN-SCRAMBLING ACRONYMS MEAN?

Answers on Page 71

1. PHEV
2. UHT
3. MRI
4. IWC
5. ASBO
6. BASE
7. RADAR
8. GIF
9. UNESCO
10. SCUBA
11. BAFTA
12. BBFC
13. PIN
14. AIDS
15. OPEC
16. GCHQ
17. UNICEF
18. PDF
19. YOLO
20. ATM

**Advertise your business  
locally in the Salhouse  
SAGA**

**VERY REASONABLE RATES**

**NO ARTWORK? WE  
CAN NOW OFFER AN  
ADVERTISEMENT DESIGN  
SERVICE FREE OF CHARGE**

**Please contact  
Richard Flatters on  
07552 233527**



**ASHLEIGH PLANTS**

**Hanging Baskets**

**Made to Order**

**Perennials and Vegetable  
Plants**

**For Spring and Early Summer  
Planting**

**Contact 01603 720520 or  
paul.roofe@btinternet.com**

# From The Parish Council



This year is an election year for the Parish Council. Local elections occur every four years, but for different councils in different years; this year is our turn. **Election Day is Thursday 4th May.** Councillors can join or leave the Council at any time, subject to vacancies, but in an election year, all the seats on the Parish Council are up for re-election. **Nominations open on Friday 17th March and close on Tuesday 4th April.** However, there will not be an actual ballot unless there are at least 12 candidates for the 11 seats available. If you ever considered joining the Parish Council, this is a great opportunity.

Please note, commencing this year, everyone will now need **photo ID in order to vote.** Further information on photo ID can be found on District and Parish Council websites.

You may have read in the press just recently that the PC has been successful again in obtaining 50/50 County **funding for minor highways improvements.** This does mean, however, that we have to find the other 50% before these schemes can go ahead! Schemes for which we obtained funding last year, most notably 'trod' paths on parts of Honeycombe Road and Thieves Lane, have got funding already and should be constructed in the course of 2023. One of last year's projects which is already up and running is the additional '**SAM-2' speed monitor** which you may see installed on the new 40 mph speed limit on Norwich Road.

The PC has been following closely the Planning Application for the **North Rackheath Development,** part of which falls within our Parish. We are keenly awaiting comments from the County Highways which are many months overdue. Other issues which are also awaited are the solutions to objections regarding mineral extraction on site and the '**Nutrient Neutrality'** issue, which is still unresolved. SPC has created a **Working Group** of councillors and residents to look into this application (see p.12).



Salhouse now has a new road name since the District Council has given the name '**Hewetson Close**' to the development of four self-build homes to the rear of Lower Street. This name was chosen from a list of suggestions submitted by the Parish Council, and follows the pattern of naming roads in Salhouse after historical figures of local significance. It refers to Capt. Philip Hewetson, whose name is on the Salhouse War Memorial, and whose letters from the trenches of WW1 are preserved at the Norfolk Records Office.

The Parish Council met with the school and local Police Beat Manager to look at **parking issues on Cheyney Avenue** particularly during school drop off and pick up times. Although the PC has investigated with Highways what improvements could be made, including the repainting of the yellow zigzag lines, the best result is for all to be courteous not to block or obstruct residents driveways (even if just for a short period) nor park on verges. The safety of the children is priority and therefore would appreciate your support with this.

We have received a number of comments on the condition of the car park at the Recreation Ground. We are looking into ways in which this can be improved, and how those improvements can be funded and also looking at the possibility of installing some new younger children's play equipment.

Finally, we are pleased to report that the roundabout at the children's playground is working well again, after a long wait for new bearings. Here, our junior engineer is seen checking for play in the roundabout bearings



If you are interested in standing for election onto the Parish Council or in joining the Working Group, please contact for more information:  
Sarah Martin - Parish Clerk – [clerk.salhousepc@gmail.com](mailto:clerk.salhousepc@gmail.com)  
or 01692 535775.

**Robert Cooper**

**Chair of Salhouse Parish Council**

# *Salhouse Parish Council*

Chair:	Robert Cooper	
Vice Chair:	Colin McCormick	
Councillors:	Nick Ball	Julie Redburn
	Andrew Peachment	Lynn Yallop
	David Francomb	John Leathers
Tree Steward:	James Cleaver	Tree Adviser: Ian Flatters

All correspondence should be addressed to the Clerk: -

## **Parish Clerk & Responsible Financial Officer:**

Mrs Sarah Martin

Spinners Cottage, 18a Honing Row, Worstead, Norfolk NR28 9RH

Phone: **01692 535775** (voicemail available)

Email: **clerk.salhousepc@gmail.com**

For more information, go to our Website: **www.salhousepc.info**

The **Parish Council** is the local authority that represents the local community, acts as first point of contact, delivers some services to meet local needs and strives to improve quality of life in the Parish.

**Broadland District Council** is the **Local Planning Authority (LPA)**. The Parish Council as a statutory consultee is consulted and can comment on Planning Applications in the Parish; however, decisions lie with the District Council.

**Broadland District Council** is responsible for:

Council Tax collection

Street cleaning

Housing

Refuse collection

Economic development

Environmental Health

Leisure facilities

Planning and Building Control

<https://www.southnorfolkandbroadland.gov.uk/>

**Norfolk County Council** provides strategic and bigger budget services to the County, including Highways, Social Services, Trading Standards, Fire and Rescue, Transport, and Education - <https://www.norfolk.gov.uk/>

To report a **Highways defect**:

<https://www.norfolk.gov.uk/roads-and-transport/roads/report-a-problem>

To report **Flooding**:

<https://www.norfolk.gov.uk/safety/floods>



## Salhouse Parish Council Meetings 2023

Monday 13<sup>th</sup> March

Wednesday 12th April

Monday 15th May (Annual Parish Council Meeting)

Monday 12th June

Monday 10th July

**Annual Parish Meeting:** Wednesday 19th April

Meetings will normally be held on the second Monday of each month at 7.00 pm at Salhouse Jubilee Hall, unless advised otherwise

**Village Website:** due to the retirement of the Webmaster and the software being no longer supported, the **salhousevillage.org** website is not being updated, but it may still be found by some search engines. Information is liable to become increasingly out of date. We regret we have no control over this.

**For current Village information, please go to: [www.salhousepc.info](http://www.salhousepc.info)**

## Salhouse United Charities – in times of uncertainty

In changing times, isn't it reassuring to find that some things don't change! Salhouse United Charities traces its origins to the Victorian era and was established to provide assistance with fuel for energy to those in need. Today, the charity still provides financial assistance to those in the village who are in genuine need. But whilst energy costs are in the news, the charity recognises there might be other needs too.

Could this be you? Or someone you know?

If so, get in touch with us and all requests will be given serious consideration and handled in the strictest confidence.

The contact point for Salhouse United Charities is Mrs Pauline Garner, telephone number 721201.

The trustees of Salhouse United Charities are: Mr Simon Gay (Chair), Mr Martin Murrell (Vice-chair), Mrs Pauline Garner (Secretary), Mr Robert Cooper, Rev Darleen Plattin & Mr Stephen Piper.

# Update from your County and District Councillors

## Fran Whymark and Martin Murrell

Locally we were pleased to see the Bell and Lodge getting a new lease of life. I hope that the whole community can give them both the support they need to become thriving businesses again. Likewise, the lease is now available at the Sole and Heel, let's hope that too will become a destination for local people soon.

At Broadland District Council (BDC) the Council have agreed that Council Tax will be frozen again to help our residents. This has only been possible due to good financial management over many years and I am confident this can continue in the future.

If you are struggling to pay the bills, or just need some advice, please call the Help Hub at BDC on 01603 430431; email: [helphub@southnorfolkandbroadland.gov.uk](mailto:helphub@southnorfolkandbroadland.gov.uk) or go to the website: [www.southnorfolkandbroadland.gov.uk/help-hub-1](http://www.southnorfolkandbroadland.gov.uk/help-hub-1).

Norfolk County Council (NCC) are also offering help through the Norfolk Assistance Scheme, call 0344 800 8020 or go to: [www.norfolk.gov.uk](http://www.norfolk.gov.uk) and click the link 'Help with living costs'.

NCC have agreed a 4.99% increase in their part of the Council Tax. This is due to inflationary pressures, not least the additional costs of Adult Social Care (ASC). 2% of the increase will be ringfenced for ASC, with the other 2.99% supporting a general increase.

NCC and Central Government have agreed a County Deal in principle. This would transfer funding and powers to Norfolk, allowing decisions previously made in Whitehall to be devolved to Norfolk, so Norfolk people can make decisions for Norfolk. The Deal would release funding for infrastructure, housing, employment, adult education and transport planning. There is a public consultation until 20<sup>th</sup> March. To share your views go to [www.norfolk.gov.uk](http://www.norfolk.gov.uk) and follow the link for 'Norfolk County Deal', email [haveyoursay@norfolk.gov.uk](mailto:haveyoursay@norfolk.gov.uk) or call 0344 800 8020.

A reminder that we have Parish and District Council elections on 4<sup>th</sup> May this year. Maybe this is the time to think about joining your Parish Council? If you need to you can register to vote at [www.gov.uk/register-to-vote](http://www.gov.uk/register-to-vote), all you need is your National Insurance number. When you come out to vote from 4<sup>th</sup> May onwards you will need photo identification (ID). Most people will have a driving licence or passport (or another acceptable form of ID) but if you do not you can get free photo ID by going to [www.gov.uk/apply-for-photo-id-voter-authority-certificate](http://www.gov.uk/apply-for-photo-id-voter-authority-certificate). You can also follow the links at [www.southnorfolkandbroadland.gov.uk/elections](http://www.southnorfolkandbroadland.gov.uk/elections), to register to vote, get your voter ID or register for a postal vote.

Take care of yourselves and each other.

### **Martin Murrell**

Broadland District Councillor for the Wroxham Ward

Email: [cllr.martin.murrell@southnorfolkandbroadland.gov.uk](mailto:cllr.martin.murrell@southnorfolkandbroadland.gov.uk)

Tel: 07958 393059

### **Fran Whymark**

Broadland District Councillor for the Wroxham Ward and Portfolio Holder for Communities, Housing and Planning

Email: [cllr.fran.whymark@southnorfolkandbroadland.gov.uk](mailto:cllr.fran.whymark@southnorfolkandbroadland.gov.uk)

Tel: 07907163123

County Councillor for the Wroxham Division

Email: [fran.whymark.cllr@norfolk.gov.uk](mailto:fran.whymark.cllr@norfolk.gov.uk)



Cllr Fran Whymark



@CllrFran

### **Find a Planning Application**

The District Council Planning Portal has changed. See a brief guide on how to access a Planning Application on Page 38

### **Salhouse Warm Space**

The decision has been taken to permanently close the Salhouse 'Warm Space' sessions on Monday mornings at the Jubilee Hall due to lack of takeup. Those needing Council support can of course still contact the Early Help Hub on 01603 430431 or Broadland Community Support Assistant Matthew Browne on 07970957650.

# North Rackheath Development (GT16) Working Group

It is acknowledged that the North Rackheath Development (GT16) is a significant development that has the potential to impact on a number of residents and businesses within Salhouse and the surrounding areas.

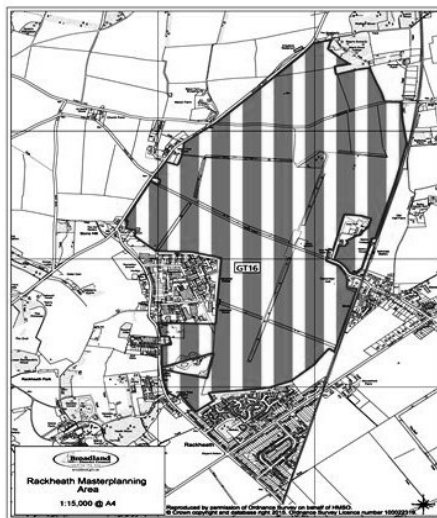

Everyone has the opportunity to submit comments directly to Broadland District Council planning application via the planning portal, but Salhouse Parish Council (SPC) are keen to ensure that the views of all Salhouse residents are heard and that residents are kept informed of the progress of this development.

As a result, SPC has initiated a Working Group and are looking for Salhouse residents to be part of this group. The objectives of this working group are to:

- Monitor plans/actions/activities by the various stakeholders for the proposed development and provide comment/observations (via recommendations to Salhouse Parish Council (SPC)) in this regard.
- Remain fair and neutral in all its activities and ensure the views and needs of all parishioners are considered equally with regards to any recommendations made to the SPC.

The Working Group will submit a report monthly to the SPC and will be available on the SPC website. Regular updates will also be made via the SAGA.

If you are interested in joining this Working Group, please contact:

Sarah Martin - Parish Clerk – [clerk.salhousepc@gmail.com](mailto:clerk.salhousepc@gmail.com) or 01692 535775.

1965 - 2015  
50  
years  
of excellence

**mb**  
Max Bidwells

- Free estimates,
- Reliable and family-run
- Local collection and delivery
- Competitive prices
- All work guaranteed
- From minor to major repairs
- Trading in Rackheath for 50 years

  
**Vehicle Repair Centre  
Accident Specialists**

**Bidwell Road, Rackheath Ind Est,  
Rackheath, Norwich NR13 6LH**

**Phone/Fax: 01603 720790**

**Email: max\_bidwell@btconnect.com**

## The Mower Doctor

**Extremely competitive prices with  
NO VAT**

**Fixed price servicing  
Prompt mobile repairs  
All garden machinery servicing,  
repairs, chain/blade sharpening  
undertaken**

**Themowerdoctorwroxham@gmail.com**

**01603 291927  
or  
07799530015**



## CTP CARPETS

All Carpets, Natural Flooring & Vinyl  
SUPPLIED & FITTED

**FREE Quote with No Obligation**

Contact us on 07931 258809  
or 07979 158457

**chrispegguk@aol.com**

**Over 50 Years Experience**

**Salhouse Based**

## Handy Andy

Your Local Odd Job Man

Need help around the  
garden or home ?

**NO JOB TOO SMALL**

Telephone 01603 720573

Mobile 07833220212





## Health Matters – Spring 2023

*An occasional update from*  
***Hoveton & Wroxham Medical Centre***



**Minor Injury Service**—During our normal opening hours (0830– 1800), we can care for patients with minor injuries, who would otherwise need to attend A&E. Our team can deal with the following: cuts/lacerations (capable of simple closure), minor trauma (sprains), minor dislocations, foreign objects, superficial eye injury, minor head injury (no loss of consciousness), minor burns/scolds (less than 4cm, not involving hands, feet, face, neck).

**Hanging on the Telephone?** - Unless you need urgent advice, you are advised to use our website to seek help for a health problem. Our well-trained Reception team will then identify the right person to solve your health problem. Our GPs have tasked our receptionists to ask about the nature of the health problem so that you can be helped in the most effective and efficient way. Please cooperate with our reception team.

**Payment Options**—Some private health checks and other correspondence prepared by a GP attracts a fee. Due to our bank's high processing charge we are no longer able to accept payment by cheque. Payment can be made by cash or via debit/credit card.

**Tackling Winter Pressures**—With our partners in North Norfolk Primary Care (NNPC) we are offering increased capacity with the introduction in February of an Acute Respiratory Infection clinic on Mondays at Hoveton & Wroxham Medical Centre. This also operates at neighbouring practices, and we may well request that you attend other surgeries if you can. NNPC are also providing a home visiting service to complement our visiting GPs, to help us reduce hospital admissions and attend to newly discharged patients with complex care needs.

**Let's Reduce Waste** – Appointments and medicines are valuable. Most of our patients are generally very good at attending appointments on time. That said, every appointment counts and there were 226 missed appointments in January 2023 – some 5% of appointments. This is equivalent to more than 40 hours - a whole week of GP or nurse time. Financially this amounts to at least £50,000 a year wasted. Please help us reduce this waste. We are also asking patients to help reduce medicine wastage – a huge cost to the NHS. In particular, please don't stockpile and do not reorder from repeat lists unless you know that you will run out.

**Your Patient Participation Group Needs You**—The PPG meets bi-monthly and provides valuable feedback to the Manager and GP partners of Hoveton & Wroxham Medical Centre. All matters affecting the service we provide to patients are addressed together with future changes. If you can spare an hour of your time, please get in contact.





## NEW MEDICAL CENTRE IN RACKHEATH – UPDATE

**The Background** -After years of planning, we are close to realising the prospect of a new medical centre in Rackheath. The Centre will be a Primary Care Health Hub and host GP and other primary care services such as community district nursing team, physiotherapy and mental health support services. The Hoveton & Wroxham Medical Centre Practice Manager, Chris Stace, and an NHS Estates lead representative (Paul Higham) presented plans to locals at The Pavilion in Rackheath on 14 June 2022. We will repeat this presentation once the final approvals have been granted mid-next year.

**The Approvals Process**—The Department of Health and Social Care gave conditional ‘programme approval’ in September. This has allowed the final and full business case for the new medical centre to proceed. There remains some small risk to the project as the financial limits are fixed and inflation is having an effect. NHS Property Services are managing the project and Darwin Group are the chosen builders. Detailed building design has commenced and District Council planning activity is running in parallel.

**The Building** - The fixed target of having the Centre operational in mid-2024 means that modern methods of construction (MMC) will be used. Much of the building will be constructed off-site and then assembled on-site, which is on Broad Lane to the west of the rail crossing. MMC will allow for an attractive exterior design and good environment for patients and staff.

**The Patients – Registration**—The location of the new Centre is within the boundaries of several current GP practices in North Norfolk and East Norwich. A carefully timed and managed process of practice boundary changes will take place to ensure that the Centre can be used for the convenience of patients in the area, for example, Hoveton & Wroxham Medical Centre patients ‘south of the Wroxham bridge’ in Rackheath and Salhouse, and those in villages and new houses around the NDR. Timely recruitment will ensure a good quality service is available for patients from day one, expanding at the pace of growing demand, with the building have a long-term capacity of 10,000.

**The Operation** The NHS Integrated Care Board (ICB) for Norfolk & Waveney (the old CCG) will own the new building and operational management will be delegated to Hoveton & Wroxham Medical Centre for effective and efficient use of the Centre as patient numbers grow over the coming years. General Practice is seeing an ever-increasing range of specialist clinicians to meet patient needs: GPs, trainee GPs, various nursing specialities, pharmacists & pharmacy technicians, physios, mental health councillors and more. Norfolk Community Health and Care district nurse and associated clinics will operate from the Centre, and we envisage some NNUH and other health care clinics being run for the convenience of patients. This does not include additional dentistry services for the time being.

**Feedback or questions?** - See our website or Facebook page, or contact the Patient Participation Group at [ppg.hwmc@nhs.net](mailto:ppg.hwmc@nhs.net)

**Let’s Keep Talking**—Tony Emes is a member of the Hoveton & Wroxham Medical Centre Patient Participation Group (PPG) and our patient representative on the Project’s Engagement Group. In due course we will engage with him and patients to influence aspects of the building detailed design and future operations. His contact details are: [tony.emes@btinternet.com](mailto:tony.emes@btinternet.com)

## PC 855 Al Jennings

### Beat Manager—Thorpe St.Andrew

Email: [allan.jennings@norfolk.police.uk](mailto:allan.jennings@norfolk.police.uk)

Phone: 101—ext.6724

Twitter: @BroadlandPolice



### PC Jennings tackles Salhouse school parking complaints

Beat Manager PC Al Jennings recently met with Salhouse Parish Council and the Primary School’s Head Teacher to discuss community concerns over dangerous and inconvenient parking on Cheyney Avenue, mainly outside the school during drop-off and pick-up times.

A collaborative approach to address the issue included asking Highways to visit the area and assess the situation. They have agreed to review the problem soon, and any necessary steps needed to combat it will hopefully be implemented.

Highways have been asked to look at the proposed idea of extending the zig-zag lines outside the school, which indicates the area where stopping or waiting is strictly prohibited, and to repaint the faded lines to make restrictions clearer.

For updates on this issue and any other work going on in your area, follow our social media accounts (@BroadlandPolice on most platforms).

You can also email PC Jennings about a local issue at:

[SNThorpeStAndrew@norfolk.police.uk](mailto:SNThorpeStAndrew@norfolk.police.uk)

# ABBAY PETS

REMEMBRANCE GARDENS & CREMATORIA

Britons Lane, Beeston Regis, Sheringham NR26 8TP (Est 1989)

**WE OFFER A PERSONAL & SYMPATHETIC SERVICE WITH INDIVIDUAL CREMATIONS & A COLLECTION SERVICE.**

**Prices from £110**

Contact us 7 days a week, 24 hours a day  
on 01603 720777, 01263 825960,  
or mobile 07771 700524

**[www.abbey-pets.co.uk](http://www.abbey-pets.co.uk)**

*All major credit  
cards accepted*



## AAA Pest Control

- npta Qualified
- Fully Insured
- Free Estimates given
- Domestic, Commercial & Agricultural
  
- Wasps, Rats, Mice, Moles, Rabbits, Ants, Bedbugs, Carpet Moth, Foxes, Pigeons and more.....



Trevor Wilson

01603 721547 / 07889 956159

[trevor@twwilson.plus.com](mailto:trevor@twwilson.plus.com)

[www.aaa-pestcontrol.co.uk](http://www.aaa-pestcontrol.co.uk)

# Improve, Don't Move!

Maximise the value of your home.

- SPACE-SAVING - MAXIMISE YOUR GARAGE HEADROOM
- SECURITY-ENABLED AUTO-LOCKING SYSTEM
- CHOICE OF 21 COLOURS TO MATCH YOUR HOME
- REMOVAL AND RECYCLING OF YOUR OLD DOOR
- DEDICATED AFTER-CARE TEAM

**GAROLLA** 01603 905 302

**ROLLER  
SHUTTER  
DOORS**



LINES OPEN 7 DAYS A WEEK

[www.garolla.co.uk](http://www.garolla.co.uk)



BESPOKE ELECTRIC DOORS MANUFACTURED IN THE UK

**FREE  
FITTING  
PAYMENT ON  
INSTALLATION**



**PRICED  
EXAMPLE £895**  
COMPACT • UP TO 2.4M



**GAROLLA ★ PREMIUM**  
Increased Security • Double Insulation  
One-Touch Close

**PRICED  
EXAMPLE £1,990**  
PREMIUM ★ 3.4M ★ ANTHRACITE

# BLOCKBUSTER DRAIN SERVICE

4 Spar Road, St Faiths Industrial Estate, Norwich, Norfolk, NR6 6BZ

Telephone Number: 01603 429 174 Email: [info@blockbusterdrainservice.co.uk](mailto:info@blockbusterdrainservice.co.uk)

- Drain blockages cleared with minimal fuss includes toilets, sinks, baths and showers
- CCTV Survey specialists -Reports provided
- Re-lining and remedial quotes upon request
- Emergency call out service available
- Family run business established since 1977



**Call locally on 01603 429 174**

# Foot Health Professional

**Charlotte Watson**

*MCFHP, MAFHP  
Fully Qualified & Insured*

## Home Visits

Treatment of all foot problems  
& finishing with foot massage

*Call Charlotte*

**01603 721646**

## Feel WARM, COSY & SAFE

with a Woodburner from Norfolk Woodburners!

Installation of  
Wood Burners &  
Multi-Fuel Stoves

Chimneys Lined

No Chimney,  
No Problem!

Fireplace Build  
Works



Main agents for  
Parkray, Hunter &  
Woolly Mammoth Stoves

clearSkies  
environmental



Offering the best LOCAL SERVICE!

T: 01508 558147 | M: 07847 426953  
E: [norfolkwoodburners@outlook.com](mailto:norfolkwoodburners@outlook.com)

[www.norfolkwoodburners.co.uk](http://www.norfolkwoodburners.co.uk)

## SCREENED TOP- SOIL

\*FENSOIL\* WOOD CHIP MULCH

\*WELL ROTTED MUSHROOM  
COMPOST, FIREWOOD

\*SAND & SHINGLE ETC

DAILY DELIVERIES THROUGHOUT  
EAST ANGLIA

FOR COMPETITIVE RATES  
& PROMPT SERVICE

## G.NICHOLLS

EST. 1960's

### NORWICH

**Tel: 720224 & 701190**

E-mail:

[info@gnichollsservices.co.uk](mailto:info@gnichollsservices.co.uk)

[www.gnicholls-services.co.uk](http://www.gnicholls-services.co.uk)

Oaks Farm, Toad Lane, Gt Plumstead,  
Norwich NR13 5EQ

# CAROLE TIMS

G.T.C.L., A.R.C.M.

**Singing and Piano Teacher  
Registered Teacher, I.S.M.**

**16 Mill Road, Salhouse,  
Norwich NR13 6QE  
Tel: (01603) 721912**

**Singing lessons, beginners to  
advanced. Choral conducting,  
Consultation and coaching.**



# From the Rectory

## Dear Friends

*Hot cross buns, hot cross buns, one a penny, two a penny, hot cross buns*, went the Victorian chant but it seems that the spicy currant bun marked with a cross and traditionally eaten on Good Friday has undergone something of a revolution. For several years now hot cross buns have been available to eat all year round and now they are available in a variety of different flavours including, chocolate, apple, salted caramel, berry, coffee, St. Clements, toffee, cheese & tomato and yes, marmite! It seems that the humble hot cross bun designed to remind us of the cross on which Jesus died has become something of a gourmet item.

The one thing that hasn't changed is the cross on the top of the bun and neither has the message that the cross conveys. A message of love and forgiveness, a reminder that Jesus Christ died so that each and everyone of us can know the love that God has for us, a reminder that on the cross Jesus died for our sins and took away the barrier that stops us from knowing forgiveness and a relationship with our heavenly father. That relationship doesn't stop at the cross; three days after the crucifixion Jesus rose again and through the resurrection God promises that his love for us will go on for all eternity.

God's love is limitless, it isn't confined to time and space, and neither is it exclusive. Having hot cross buns all year round is a great way to remember that God's love is timeless and having different varieties of bun well perhaps that is a wonderful way to remember that God's love is for everyone whatever our colour, ethnicity, age, gender, sexuality or ability.

Enjoy your hot cross buns and may you know the love of the cross and the joy of the resurrection this Easter.

With every blessing

*Darleen*

As always, Darleen is available to visit at home or in hospital (subject to Covid 19 restrictions), whether you are ill, recovering, or just want to see someone, please telephone. Communion at home can be arranged for those who require it because of illness or frailty again please telephone. Enquires for Baptisms, Thanksgiving services, Weddings and Services of Blessing after a Civil Marriage are always welcome please telephone or email. On the sad occasion of a bereavement please contact Darleen or ask the Undertaker to do so to arrange a service in Church or at the Crematorium.

**Rector: Revd Darleen Plattin**, The Rectory, 56 Green Lane West, Rackheath, NR13 6PG. Tel: 01603 720966.

Email: darleenplattin@btinternet.com



### **Services for Holy Week and Easter in the Bittern Benefice**

Palm Sunday (2<sup>nd</sup> April), 10.30am: Holy Communion at Lt Plumstead.

Maundy Thursday (6<sup>th</sup>) 6.30pm: Holy Communion at Rackheath

Good Friday (7<sup>th</sup>) 10.30am: Good Friday Liturgy & Holy Communion at Rackheath followed by hotcross buns & coffee.

Easter Sunday (9<sup>th</sup>) 10.30am: Holy Communion at Rackheath.

### **Regular Services in The Bittern Benefice**

All Sunday services are held at 10.30am and rotate around the Benefice. Please see the church noticeboard for up to date details.

Salhouse Church is normally open daily between 10am and 3pm



# Wroxham WI



I am very sorry to have to tell you that our branch of the WI will close with our meeting on 15 March. It had become increasingly difficult, over the last few years, to get people to volunteer for the committee and also to offer to become any of the officers of the branch such as President, Secretary etc. Although not too difficult, there is a certain amount of work and dedication needed to run a WI branch and people these days have many other calls on their time. So the decision had to be taken, after close consultation with our Norfolk head office in Norwich, to close us down.

We all have many fond memories of Wroxham WI, from Christmas tree festivals, pantomime productions by our talented members, visits to interesting places, including to The London Shard with afternoon tea and a quick twirl round Borough Market afterwards. There was a gentle whiff of cheeses from the market on the way home in the coach after that one!

Our speakers at every meeting have been mainly of interest and information although a very few have been not quite as promising as we might have hoped!

The friendships we have formed over the years have been deep and long-lasting. We have seen each other through family crises, serious illness and the loss of our closest dear ones. We have indeed been blessed.

It will seem strange not to go to WI every month. But I know that Rackheath WI would be pleased to welcome new members. Please go along and continue your support of Norfolk WI. **Roz Watt**



# Rackheath WI



Ladies, a warm welcome awaits at Rackheath Evening WI who meet on the fourth Thursday of every month at Holy Trinity Church, Salhouse Road, Rackheath, NR13 6PD at 7:30 pm.

Every month we host a variety of speakers followed by refreshments and a raffle. There are regular Monthly walks, outings; theatre trips and a variety of activities are being considered.

The 2023 programme includes a Murder Mystery Evening with Julie Porter, a Tropic Skin Care Demonstration with Kerry Skelton, Kitchen Chemistry with Dr Ashworth, Christmas Sparkle, Flower Arranging with Chrystal Dyball and English Country Dancing with Chris Davis, also a Quiz and Chips fundraising event and an enjoyable Christmas Celebration.

There is also the opportunity to take part in events organised by Norfolk Federation. A summer evening Garden Party at Peter Beales Roses, Attleborough and on a regular basis Nosh and Natter Lunches at Evelyn Suffield House in Norwich, and many courses to help with modern technology like i-Phones and ebay.

Many lasting friendships have begun at Rackheath WI and we offer fun, friendship and support to all who join us.

If you are feel this is for you please contact President, **Frances Pointer** 01603 720796 or Secretary, **Jane Nock** 01603 438363 for more details.

## **RACKHEATH PHARMACY**

**Tel: (01603) 721156**

1 Bernard Close, (off Vera Road)

Rackheath, NR13 6QS

**Email: [rackheath@loyalpharm.com](mailto:rackheath@loyalpharm.com)**

Opening Hours:

Monday to Friday: 09:00 – 18:00

Saturday: 09:00 – 13:00

Sunday: CLOSED

**WE ARE OPEN DURING LUNCHTIME**



**STAY LOCAL – STAY**

During these uncertain times, your local pharmacy team is still working hard to ensure that you get your much-needed medication. We also have plenty of winter season medicine in stock and if there is anything you need in particular, we will try our very best to obtain it for you. We look forward to seeing you at your LOCAL Community Pharmacy.

Conveniently located in Rackheath next to the shop/post office on Vera Road, we at Rackheath Pharmacy can take your regular prescription requests by telephone, email, by post or in person. We provide many other services which include: Medication in Dosette Boxes/Trays - Blood Pressure Monitoring - Health Checks – Erectile Dysfunction – Emergency Contraception.

We also provide services to Care Homes and why not ask about our delivery service

Our friendly and helpful staff are always on hand to help and advise and we offer a range of over the counter products.

Ask your surgery to nominate us as your local pharmacy and we look forward to meeting you.

A friendly and professional pharmacy for all your medical needs. Let's keep our NHS team safe

**HANDS – FACE – SPACE**

## **ROBERT HOLDEN SAAB SPECIALIST**

*Wood Green, Station Road  
Salhouse, Norwich, NR13 6NS*

**Tel: 01603 722811**

***[robert@saab-specialist.co.uk](mailto:robert@saab-specialist.co.uk)***

***[www.saab-specialist.co.uk](http://www.saab-specialist.co.uk)***

# Salhouse Service Centre

Small enough to care, large enough to cope.



Owner: Richard Bales

We are open for servicing, MOT preparation and all general repairs on cars

We would be delighted to see all customers, old and new

Come and visit us for a free quotation and advice on your vehicle

The Old Forge  
232 Norwich Rd  
Wroxham  
Norwich  
NR12 8SL

Courtesy car available  
(with prior notice)

Local collection and return of  
vehicle (with prior arrangement)

**Garage:** 01603 722974  
**Mobile:** 07798 612376  
**After Hours:** 01692 581191  
**E-mail:** ssc07@btconnect.com



## Broadland Architectural

### Architectural Design Services

Local Based, Affordable, Professional, &  
Personal Service for Full Range of  
Architectural Design Solutions, from Initial  
Design Concepts thro' to Final Approval



Drawings for Planning Permission & Building Reg's Approval  
Alterations - Extensions - New Build - Listed Buildings  
Full Design Service - From Small Extensions to New Homes

[www.broadlandplanning.co.uk](http://www.broadlandplanning.co.uk)



Free Quotations or Advice -  
Visit Website or Call:

**01603 720148**

# Community Pub Campaign Report

As a Community Group, we've been considering our next steps now that The Bell has been sold and is undergoing refurbishment by the new owners. We don't believe there is capacity for a Community Shop mainly run by volunteers in the village at this point. Instead, we are going to morph into a **'Community Events Team'** with a view to putting on Fun Events for all the village.

Our first event will be on the afternoon of **Sunday 7th May**.

**We'll be celebrating the Bank Holiday Weekend with the**

## **Coronation Big Lunch**

a big outdoor bash on the Recreation Ground in Salhouse.

There'll be a bar, food, music, lots of things for the kids (we're planning face painting, bouncy castle, ice creams, football tournament etc.).

It'll be fun for all the family. Lots more info to come in the coming weeks as we approach the Spring.

If you'd be willing to offer a few hours of your time to help on the day or with set up/clean up, do let us know. Similarly, if you want to be actively involved on the music/catering side of things by performing/selling your wares, please get in touch at

[salhousebellcommunity@gmail.com](mailto:salhousebellcommunity@gmail.com).

We'd love to hear from you.

## Salhouse Baptist Chapel

After approximately 220 years, the chapel has closed. A good deal of the earlier history was recorded in chapter 8 of 'The Book of Salhouse and Woodbastwick', the excellent volume on the village history. Whilst there have been good periods of large congregations, perhaps numbering 150 or so for some of the 19<sup>th</sup> century, there have been many years where the chapel has struggled for lack of attendees. Indeed, I remember being brought in the 1970s as a teenager by my father who was amongst a group of men in Suffolk determined to keep the chapel open. A quick glance at the records reveals that for quite a significant part of the 20<sup>th</sup> century, there were frequent gaps when the chapel wasn't open.

But, its not the end of the church, nor indeed was it the beginning when the first group of a dozen or so met in 1802 to construct a place of worship in the village. The Bible reminds us that the church isn't the building, but the people. And the church began at the day of Pentecost, as recorded in Acts 2, when Peter's remarkable sermon was delivered with astounding results. Not just the 3,000 converted on that occasion, but it was the seed of the church, and 2,000 years later people are meeting across the world. Some in elaborate buildings, some in tin huts, some in homes, some amongst vast numbers, others a small handful. In 2019 I was privileged to spend a few weeks in Africa teaching pastors from war-torn South Sudan. I remember one man very well; he addresses a congregation of over 100 each week, and they meet under a tree.

But here in Salhouse, the declining number was something we wrestled with throughout 2022. We had to face the reality that there was a lack of local interest, and we recognise that we are in the fortunate position where there is still freedom to meet, and a relatively large number of congregations can be found within a short drive.

There is more good news. Even though a building has closed, the good news of the gospel, salvation in Jesus Christ, is still preached, proclaimed and gossiped and this is still a day of opportunity. Isaiah 55v6 tells us to "seek the Lord while he may be found". Perhaps you've left it, put it to the back of your mind, thought there'll always be another day. Well, Peter reminds us not to trade on the patience of God, 2 Peter 3v9.

And the church, worldwide, is larger today than at any time in history. The words of Jesus in Matthew 16v18 are true: he is building his church, and nothing will prevent its accomplishment.

The message preached, the good news proclaimed, the salvation of Jesus Christ hasn't changed, not one bit. Just not in the old building up the Loke. But he is still to be found.

For the moment, I'm in the village and I'd be pleased to speak with anyone who would like to chat further and find what they're missing.

**Simon**

# J NEWTON GROUNDWORKS

No job too large or small

Block paving  
Slab/kerb laying  
Driveways - Construction & resurfacing (Brickweave or Asphalt)  
Garden clearance

Call for **FREE** quotation

**01603 720047**

**07768014642**

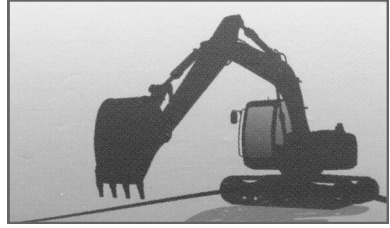

**Jamie Newton**

jimbob13@hotmail.co.uk

13 BERNARD CLOSE  
RACKHEATH  
NORWICH

## The Old Barn B&B

CHARMING CONVERTED BARN  
NEAR SALHOUSE BROAD

1 GOOD SIZED  
TWIN BEDDED ROOM  
GROUND FLOOR

OWN BATHROOM & TV LOUNGE

Sue Simpson, The Old Barn,,  
2 Upper St, Salhouse,  
Norwich, NR13 6RY

**Tel: 01603 721759**

## Critten Electrical

(est 1967)

For all kinds of electrical work.

Re-wires, new  
Fuse-boards etc.  
Free estimates  
Reliable, experienced  
Friendly service  
Competitive rates  
Nic registered  
Insurance backed

**Ring Nigel Critten  
on**

**01603 722163**



**Rachel**  
**Mobile hairdresser**

**Hairdressing in the comfort of your own home. Colours, highlights, cuts and perms. Fully qualified and insured. DBS checked. Call Rachel on 07900094573**



*The Poppy Room*



*Pamper yourself*

*Manicures . Pedicures . Vegan gel polish*

*Facials . Waxing . Tinting*

*Rackheath*

*Tel 07979 107143*

# HOWES MOTOR ENGINEERS

37 Salhouse Road, Rackheath, Norwich, NR13 6PD

TEL: 01603 721881



## DISCOUNTED MOT'S



*FULL GARAGE FACILITIES FOR  
MOT'S . SERVICING . DIAGNOSTICS . AIR CON.  
CLUTCHES . TYRES . BRAKES . CAMBELTS .  
WELDING & ALL MECHANICAL REPAIRS ON  
ALL MAKES OF CARS AND LIGHT  
COMMERCIAL VEHICLES*

*Free collection & delivery service available on request  
(subject to availability)*



## HOWES MOTOR COMPANY

**QUALITY USED CAR SALES PART EXCHANGE WELCOME**

**TEL: 01603 721881**

**AFTER HOURS: 07768 470107 (CAR SALES ONLY)**



# Anglia

NORWICH  
GAS SERVICES

Natural Gas and LPG Specialists

- \*Gas & LPG Boiler & Appliance Servicing
- \*Oil Boiler Servicing
- \*Installations
- \*Boiler replacements
- \*Full Heating Systems
- \*System Power Flushing
- \*Underfloor Heating
- \*Control Upgrades
- \*Bathroom & Wet room Installations

All Plumbing and Heating work undertaken.  
Our small, friendly team are fully insured and Gas Safe registered.  
Competitively priced.

Email: [enquiries@anglia-gas.co.uk](mailto:enquiries@anglia-gas.co.uk)

Mobile: 07881 783073

Website: [www.anglia-gas.co.uk](http://www.anglia-gas.co.uk)

Call your Local Domestic Appliance  
Repair Engineer.

## Andrew Brierton

### Domestic Appliance



### Repairs



### Free Call Out

Factory Trained.

Zanussi, AEG, Hoover, Hotpoint,

Servis, Indesit, Bendix, Bosch,

Electrolux Etc.

All Appliances



Prompt, reliable and friendly service  
Telephone Andy on 01603 890429  
Mobile: 07900003794

## GUY HUBBARD

### DOUBLE GLAZING



CONSERVATORIES,  
WINDOWS & DOORS  
In PVCu.

FASCIAS  
BARGEBOARDS  
GUTTERING  
CLADDING  
Sealed Unit Replacements

Free  
Quotes  
No  
Hard Sell

*All aspects of Installation Professionally Undertaken  
With 10 Year Guarantee On All Materials & Work.*



01603  
737274

[www.guyhubbard.com](http://www.guyhubbard.com)

**FENSA**  
Registered Company

Farringford,  
Market St.,  
Tunstead,  
Norwich.  
NR12 8AH.

# Wroxham Library



Below are some of the events and services we offer but see our Facebook page or call the library on 01603 782560.

- **NEW—Coding Club** Every Saturday 2-3pm, Ages 7 -11, limited to two spaces. To book a place please call us on 01603 782560 or email: [Wroxham.lib@libraries.norfolk.gov.uk](mailto:Wroxham.lib@libraries.norfolk.gov.uk)
- **Chess**—Last Thursday of the month, 10.30 - midday. Beginners welcome.
- **Lego and Art club**—Every Wednesday 3.30 - 4.30pm. Put your building skills to the test or relax and get creative at our combined Lego and Art Club. For children aged 5 -11. Under 8s must be accompanied.
- **Knit and Natter – not just for knitters!** Bring your embroidery, textile, or crochet project along to our informal gathering. First and Third Thursdays of each month, 2.00- 4.00pm
- **Crib Club** (Cribbage card game) – new players welcome –Second Thursday of each month 2.00-4:00pm. Please bring your own board and cards if you have them.
- **Scrabble Club**—Last Thursday of each month from 2.00-4.00pm. All welcome.
- **Thinking of starting up or growing your own business?** As a Local Business and IP Centre, we have free access to a wide range of business resources at Wroxham library. Find out more at: [www.norfolk.gov.uk/bipcnorfolk](http://www.norfolk.gov.uk/bipcnorfolk)
- **Just a Cuppa**—every Tuesday 10.00 – 12pm. Come along for a friendly chat over a cup of tea or coffee and a biscuit.

- Our 'Bounce and Rhyme' sessions take place on Wednesday at 10.30am. No need to book just drop in and sing along!
- **Story Explorers** is a reading adventure for children aged 0 – 5. To sign up and find out more, simply visit the library and speak to a member of staff .
- **Family History** – Use our free access to Find My Past any time the library is open. Drop-in on Wednesday and Friday evenings between 4.00pm and 6.00pm to get advice from Diane, our family and local history expert.
- Book one 60 or 120 minute session per day on a computer. Contact the library on 01603 782560.
- Return items through the drop box or self-service kiosks
- Download the FREE Spydus app to check out books on your smartphone.
- Download eBooks, audio books, newspapers and magazines by visiting [www.norfolk.gov.uk/libraries](http://www.norfolk.gov.uk/libraries)
- Use our self-service Baby Weigh Scales on request.

### **Housebound Library Service**

If you are unable to get out to the library to get your library books, we can bring them to you! Details from the library.

**Our normal opening hours are below, though please check for updates on our Facebook and Webpages. We have further extended our opening hours with the Open Library service – contact the library for more information.**

- Monday: Closed
- Tuesday: 10 - 7
- Wednesday: 10- 7
- Thursday: 10-7
- Friday: 10-7
- Saturday: 10- 4
- Sunday: Closed

Visit our Facebook page <https://www.facebook.com/wroxhamlibraryofficial>

Or our website [www.norfolk.gov.uk/libraries](http://www.norfolk.gov.uk/libraries) for updates on events and activities.

**Wroxham Library, Norfolk Library and Information Service, Norwich Road,  
Wroxham, Norwich, NR12 8RX Tel: 01603 782560**

# Update on Salhouse Pubs

Both Salhouse's village pubs changed hands late last year and both closed for refurbishment. This meant a rather 'dry' Christmas for those who would prefer to venture out locally. The good news is that both pubs should re-open under new management in the coming months.

The Salhouse Lodge, in Vicarage Road, has been taken on by Colchester Inns. Nicola Colchester, who will run the business, reports that the pub and hotel, which is currently being redecorated, will reopen in phases from mid-April. The bar and rooms will open first, with the restaurant opening at a later date. Elements of the existing pub will be kept, such as the sofas, but refurbished to match the 'modern, country feel' of the group's other pubs. The large garden and patio area will continue to host live music, which was much-loved by locals, the bar area will be made more for drinkers, and campers will still be welcome on the pub's seven acres of land.



The Salhouse Bell Inn was bought by Lester Bayfield, owner of Salhouse Hall, just before Christmas. He reports that the building was in a much poorer structural condition than he anticipated, and as a result, much more extensive renovation work has been required, with the roof having been entirely renewed recently. As an historic buildings restorer, he has the right skills for the task. When completed, there will be a comfortable drinking area, good value restaurant food and takeaways, and the traditional beer garden will be available as always in the summer. The upstairs accommodation is being converted into four holiday lets. Due to the new owner wanting to do a proper job of restoring this historic building, the re-opening date has not yet been decided, but is likely to be some time in May.



# WROXHAM FLOWER CLUB



**Now held at Rackheath Village Hall, Green Lane West, Rackheath, Norwich, NR13 6LT.** Meetings are held at 7.30pm with doors open at 7.00 pm.

**Wednesday, 12th April, 7.30 pm** - Jill Clarke will be running a Workshop for Flower Club Members.

**Wednesday, 10th May, 7.30 pm** - Bernard Collingsworth from Stalham is demonstrating arrangements entitled, "Village Life" which we have the opportunity to win in the raffle. Refreshments of home made cakes, tea and coffee are served at the end of the evening.

Visitors are very welcome at £6.00 per person to the demonstration evenings. It would be lovely to see you.

For further information please do not hesitate to give me a ring on 07539764196.

**Rosie Howell**

## THE SALHOUSE BELL READING GROUP



Yes, we are still meeting to discuss our reading selections. Due to the temporary closure of The Bell, we have relocated to Heathlands at Blofield Heath, but we are looking forward to returning when the extensive refurbishment of The Bell has been completed. Hopefully Mr and Mrs Bayfield will be on track with the reopening and find a space for us on the 1st Thursday of every month for our meetings

Just a reminder that we currently meet on the 1st Thursday of the month at 7.00 p.m. at Heathlands (\*except May, due to Elections), all welcome. We are still challenging our group with the choices made, but enjoying the company in addition to the reading.

Our current dates and books are :

- |                   |  |
|-------------------|--|
| 6th April 2023 –  | West with the Giraffes – Lynda Rutledge  |
| 11th May* 2023 –  | Unsettled Ground – Clare Fuller          |
| 1st June 2023 –   | Keeping Mum – The Dark Angels Collective |
| 6th July 2023 –   | Newhaven Court – Helen Murray            |
| 3rd August 2023 - | Winter in Madrid – C. J. Sansom          |

**Julie**

**GYM IN SALHOUSE**

WHERE FITNESS,  
COMMUNITY & LAUGHTER  
COME TOGETHER

**FITNESS**®

@ THE STREET

CONTACT STEVE OR KIM FOR MORE  
DETAILS [FITNESSATTHESTREET@GMAIL.COM](mailto:FITNESSATTHESTREET@GMAIL.COM)  
WOOD GREEN INDUSTRIAL ESTATE, STATION ROAD

Missing your papers dropping through  
the Letterbox?

**STEVE McDONALD NEWS**

Papers and magazines delivered 7 days a week

Ring 01603 437579 or call in at 27 Witard  
Road Thorpe St Andrew, NR7 9XD

# How to Search for a Planning Application

## on your District Council Website

- On the southnorfolkandbroadland.gov.uk website, (<https://www.southnorfolkandbroadland.gov.uk/>) on the Home page, click on the Planning and Building icon
- Click on 'Find and Comment on a Planning Application'
- Click on the 'South Norfolk and Broadland Planning Application' search button (<https://info.southnorfolkandbroadland.gov.uk/online-applications/>)

### For a Simple Search (if you know the Application number):

Planning – Simple Search

Search for Planning Applications and Appeals by keyword, application reference, postcode or by a single line of an address.

Simple Advanced Weekly/Monthly Lists Property Map

Applications Appeals

Status: All

Enter a keyword, reference number, postcode or single line of an address.

Search

an idox solution

- Enter the Planning Application reference number in this field, click Search.
- This brings up the application, with various information and dates.
- Click on the Documents tab, to view individual documents, by clicking on the icon at the end of each row under the View heading
- Click on the Map tab, to take you directly to the application site

### For Advanced Search

- This screen allows you to search on various fields, reference number, name, type of application, Ward, Parish, Address. Also, there are date fields to use, if you know these.

### To Use the Weekly/Monthly List

- Enter Parish or Ward with date of week commencing for application

### To Use the Property tab

- For a quicker return of results enter the Street Name and Town/Village, or use the Postcode field. Enter at least one of the options.

### Using the Map Tab

- Zoom in to where you think a site is, either by using the scroll wheel on your mouse, or using the + & - buttons, on top left hand corner of map. To move the map around, click and drag.



Do you enjoy helping others?  
Do you enjoy being a part  
of a supportive team?

Does delivering exceptional support to  
adults with learning disabilities and  
behaviours of concern sound like  
something you are good at, or would be  
good at? Then this could be the ideal job

We are excited to announce that due to  
expansion, we are looking to recruit several  
Support Workers to join our fantastic team!



### Who are we?

Currently based in Salhouse and Mundesley,  
we were established in 2014 and have been  
providing bespoke and tailored support for  
adults with learning disabilities, specialising  
in autism and behaviours of concern ever



### Why work with us?

Every day is different and if you thrive  
helping people and making a difference to  
their lives, we would welcome you to get in  
touch. We offer competitive rates of pay and  
your starting salary will be £10.50 per hour  
with plenty of scope to grow within the  
company. We pride ourselves in the  
exceptional level of support we provide to  
our Members and it really is a special place  
to be a part of.

#### Inspected and rat

Safe	Good
Effective	Good
Caring	Outstanding
Responsive	Good
Well-led	Good



### Further Information

Please get in touch with Lee on 01263  
478188 or email  
officemanager@allcarecommunity.co.uk





01603 721859

35 Salhouse Road Rackheath

# LOUISE

HAIR & BEAUTY

Nail Care  
Gift Vouchers

Monday	CLOSED
Tuesday	9.00am—5.00pm
Wednesday	9.00am—5.00pm
Thursday	9.00am—6.00pm
Friday	9.00am—6.00pm
Saturday	9.00am—2.00pm

## Thorpe End Garage



**We've been providing MOT's,  
Servicing & Repairs since 1992!**

We offer a friendly & honest service along with competitive pricing to keep your vehicle on the road.

- Brakes & Clutches
- Cambelts & Exhausts
- Tyres & Batteries
- Air Con Service & Repair
- Engine Diagnostics
- BMW & Vauxhall Specialists
- Established 1992

Mon- Fri: 8.30am-5.30pm  
Saturday: Closed  
Sunday: Closed

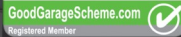

77 Plumstead Road, Thorpe End, NR13 5AJ  
T: 01603 700148

e: [enquiries@thorpeendgarage.co.uk](mailto:enquiries@thorpeendgarage.co.uk)  
[WWW.THORPEENDGARAGE.CO.UK](http://WWW.THORPEENDGARAGE.CO.UK)

## BURE VALLEY WOODBURNERS

Multi Fuel Burners Installed & supplied.  
Chimney Repairs. Fireplaces.  
Chimney Liners. Pots & Cowls.  
Bird Guards. Repairs & Servicing.



**HETAS REGISTERED**

Chris Beardsmore

01603 736073 07717 574659

[chris@burevalleywoodburners.co.uk](mailto:chris@burevalleywoodburners.co.uk)  
[www.burevalleywoodburners.co.uk](http://www.burevalleywoodburners.co.uk)

**BUILDING WORK**

Extensions. Renovations.  
Garden Walls. Lime Mortar. Guttering

# Wroxham Flower Club Open Meeting

**Tuesday 13 June 2023**

---

**Demonstrator: Lee Berrill "A wonderful world"**

---

Doors open at **12 noon**  
The New Victory Hall, Neatishead, NR12 8AD

**£20** per ticket to include a drink on arrival, a  
plated cold lunch, and tea or coffee

Please call Su Mace on **07902 140520** to book  
your ticket





Salhouse Rovers FC Under-7 Team

*Photo: Paul Wardle*



Salhouse Bell: roof replacement in progress, January 2023

*Photo: Lester Bayfield*

# Team Salhouse Welcomes Spring



...with a little word search puzzle featuring local village names

A	A	W	L	L	A	H	S	I	T	L	O	C	I	S
R	S	E	R	W	N	S	T	A	L	H	A	M	P	T
W	B	H	L	O	H	T	A	E	H	K	C	A	R	O
S	F	E	T	O	X	S	K	T	C	D	O	H	A	K
T	V	P	O	D	R	H	O	V	E	T	O	N	N	E
R	U	D	C	B	L	M	A	H	D	U	L	E	W	S
U	L	A	M	A	S	B	M	M	Q	N	U	K	O	B
M	F	G	U	S	A	L	H	O	U	S	E	C	R	Y
P	D	A	E	T	S	M	U	L	P	A	V	U	T	H
S	Z	D	G	W	I	E	N	O	T	X	U	B	H	G
H	O	R	N	I	N	G	G	M	A	H	L	I	D	U
A	F	C	X	C	W	L	L	A	D	N	U	R	B	A
W	B	Y	H	K	C	I	W	T	S	O	P	M	L	L
S	U	R	L	I	N	G	H	A	M	I	J	N	P	E
L	I	N	G	W	O	O	D	L	E	I	F	O	L	B

We are always looking for volunteers, young or not so young, to help us keep the village looking trim so, if you have an occasional hour to spare and don't mind getting a little bit grubby, we would be pleased to hear from you. **Please phone Malcolm on 721201.**

**Team Salhouse**

**“Proud of Our Village”**

Wordsearch Answers on page: 77



**Salhouse Station Group** is working to ensure the long-term survival of the remaining building at the railway station, constructed in the 1890s.

As previously reported in *Salhouse Saga*, the first job for us is to have the building surveyed to ascertain its condition so we can put a costed plan together to get, firstly, the building made watertight, before starting to restore it so that it can be put to community use as well as potentially providing better facilities for railway passengers.

So, what has been happening? Sadly, there's not much to report yet as progress has been rather frustratingly slow, largely because we have been unable to gain access to the building. However, thanks to our friends at SAVE Britain's Heritage, who first brought the plight of the building to our attention, we are very hopeful that their surveyor will be able to enter the building over the next few months.

This will enable us to get the campaign to restore the station going, set some targets and milestones and start fundraising in earnest.

Our group continues to meet regularly: we have a lot of ideas around what we can do with the station, how it can be used for a community benefit and even encourage more people to use the station. Once we know the condition and what needs doing urgently, we will be able to let the brakes off and launch the project in earnest.

Having met lots of villagers at the Christmas Fair in the Jubilee Hall, we will be supporting the **King's Coronation** event in the village in May and look forward to meeting more people to tell them about our plans. See you there!

In the meantime, and to repeat our plea from the previous *Salhouse Saga*, does anyone have any photographs, mementos or indeed memories of Salhouse station from the past that you could share with the group? If you do, please email us at [salhousestation@gmail.com](mailto:salhousestation@gmail.com). We look forward to hearing from you!

**Peter Treglown**



**Friends of Salhouse School (FOSS)** is a registered charity set up to raise funds for Salhouse Primary School. The objective of FOSS is to support the school by providing additional facilities/materials for pupils, that are not normally provided by the Local Education Authority, through fund raising and social events, and further relationships between the pupils, staff and parents and the wider community.

FOSS in the last year has supported the school by:

- Paying transport costs for a whole school trip to the hippodrome circus, which significantly reduced the cost of the trip for parents.
- Funded Year 6 leavers hoodies.
- Provided selection boxes and crackers for all children at Christmas.
- Funded music equipment, so more children can learn an instrument.
- Funded sports equipment.
- Funded globes for each classroom.
- Organised school discos for all the children.
- Provided easter eggs for every child and organised an easter trail for the children.
- Provided funding for music days and the choir.
- Provided funding for a Chinese dragon dance troupe, to support the children's topic this term.

In order to fund the above FOSS do various fund-raising events such as:

- Bake Sales
- Ice cream Fridays in summer and Hot Chocolate Fridays in the winter.
- Christmas Fayre
- Summer Fayre (this year on July 9<sup>th</sup> 2023)
- Bingo nights
- Non-school uniform days

The people on the committee are all volunteers and parents/grandparents/carers/guardians of the children at the school. We are always on the lookout for new members or fund-raising ideas, so if you would like to get involved and support the school then email FOSS at [Foss2019@yahoo.com](mailto:Foss2019@yahoo.com).

# How to Grow Vegetables – A beginners guide to growing your own

Growing your own vegetables is rewarding, healthy and fun. But it can be daunting knowing how and where to start.

It's best to grow things that need little attention, can be ready to harvest in a short time, and suffer few pests and diseases. These include courgettes, beans, beetroot, rocket, radish, chillies and potatoes.



## How to grow Vegetables

- Most vegetables like a sheltered, sunny spot. Salad leaves and some herbs, can bolt (run to seed) in full sun, and therefore do better in partial shade.
- Only grow what you have space for. If you don't have a large garden you can grow salads in window boxes, pots or growing bags.
- If planting in the ground prepare the soil by removing weeds and adding well-rotted compost or manure, and rake level.
- Don't grow plants too closely together and prick out if necessary – always follow the spacing suggestions on the seed packets.
- Deter slugs and snails using barriers such as copper tape. Use wildlife-friendly slug pellets (made using iron phosphate) only as a last resort
- If possible, start off vulnerable plants, such as salad leaves and courgettes, indoors, and plant them out when they're big enough to withstand attack from any bugs and the weather!

## Some of the best beginner vegetables to grow are:

### 1 Beetroot

Beetroot can be sown direct into shallow drills in the soil, and are ready to harvest within a few weeks. You can also eat the young leaves.

### 2 Salad Leaves

Salad leaves like rocket and oak-leaf lettuce can be sown in pots and harvested on a cut-and-come-again basis, so you don't need to tend the plants for long. There are mixed salad leaf varieties that make a colourful salad.



### **3 Bush Tomatoes**

Bush tomatoes are easier to grow than cordon varieties, as they don't need supporting and their side shoots do not require nipping out. Bush tomatoes grow well in a hanging basket or pot, in a greenhouse and outdoors.

### **4 Potatoes**

Potatoes are easy to grow – simply plant them in the ground or an old compost bag, cover the leaves with soil when they first appear (known as 'earthing up'), and harvest a few weeks later. Early potatoes (planted in early April) can be harvested in July, before hot, humid weather increases the risk of potato blight.

### **5 Peas**

Peas can be easy to grow and compact varieties can be grown in containers. The young tips can be trimmed and added to salads for a delicious spring treat, and are followed by flowers and pods.

### **6 Radishes**

Radish seeds are fairly large, so they are easy to sow and don't need thinning out. They're ready to harvest within just a few weeks.

### **7 Japanese and Chinese Salad Leaves**

Japanese leafy crops such as mizuna and mibuna and Chinese mustard can be grown as cut-and-come-again leaves. They require little attention and will provide you with a variety of flavours, colours and textures to enjoy in stir fries and salads. You can grow them in containers or in the ground.

### **8 Chillies**

Chillies grow well in pots on a window sill or in a warm, sunny position outside. They have similar growing requirements to bush tomatoes and will continue to crop until the first autumn frosts.

### **9 Courgette**

Courgettes can produce much from just a few plants. For the best results, grow your courgettes in fertile ground and water regularly, picking the courgettes when they're no longer than 10cm.

These are just a few ideas and there is lots of advice and tips available online as well as in gardening books and magazines. Some of the places to look for inspiration are:

Gardeners World <https://www.gardenersworld.com/> \*\*

Royal Horticultural Society: <https://www.rhs.org.uk/vegetables/seeds-sowing>

**Above all, enjoy your gardening and what you produce will taste wonderful.**

\*\*Taken from: <https://www.gardenersworld.com/plants/vegetable-crops-for-beginners/>

**Sarah Oldfield**

## From the Salhouse Broad Ranger



### Update from Salhouse Broad....

It's that time of year, when Paul is busily getting the winter works finished and we're gearing up for another busy season. Whatever the season may bring (and who knows in such financially uncertain times!) we will be ready. We are kicking off the season with an Easter trail, it's been a few years since we held the Easter Egg Hunt and after the success of the Halloween trail, we just had to offer something similar over the Easter break. So, keep an eye on social media for details.

If you have been to Salhouse Broad lately, you may have noticed an area of shingle, near to the Hungry Otter. This will be the base for the Dark Skies Viewing Platform and Discovery Hub. We were lucky enough to be chosen as the location for the Dark Skies Platform, which was funded by an EU cross-channel project. The platform will feature wide steps and a big net to lay on and view the night sky, we will be planning some dark skies events using the platform, so keep an eye out for those. The adjoining Discovery Hub is part of a wider project which offers information about the Broads and how Salhouse Broad links into the wider Broads area. Both projects have been led by Norfolk County Council with involvement from The Broads Trust and Love the Broads and will be built by local company; CAPCO.

Due to the ever-increasing cost of everything, we will be raising the parking charges to £1.50 per hour and £4.00 all day. HOWEVER, if you are a regular visitor of ours, you can purchase a yearly permit for just £30. Since introducing parking charges, this price has stayed the same, we will endeavour to keep the yearly permit charge low for regular visitors and if you're interested in buying one of these permits, please see the signs in the car park or contact us in the office on 01603 722775.

This winter our volunteer team have been busy, they have continued with the traditional hedge-laying at the campsite; this will thicken out the hedge at the bottom and promote new growth. They have planted some sea buckthorn near to where the new dark skies platform will be, this should suit the sandy soil and will provide some nice orange berries to help feed the birds and provide a nice contrast to the yellow gorse. They are also working on getting some native species in the 'boggy bit' beside the boardwalk and near to the beach. It will be nice for this area to have a bit of colour and interest, rather than mud! So, watch that space.

This season we will be opening on 1<sup>st</sup> April and we will be welcoming 4 new Seasonal Rangers to the team, so please say hi to them! Don't forget, The Hungry Otter will be back too, serving their lovely coffees, teas, the best sausage rolls, ice cream (it won't be long before the sun shines!) and more besides. Whether you pop down for a coffee, a dog walk, a paddle or a camp, we will be ready to welcome you.



The Salhouse Broad Ranger Team

[www.salhousebroad.org.uk](http://www.salhousebroad.org.uk)

01603 722775

theranger@salhousebroad.org.uk

Photo: Gemma Hampton—Generations Photography

# Fencing Patios & Driveways

**\*FREE QUOTATIONS \***

Close Board Fencing,  
Budget panels, Picket fencing  
Concrete or wood posts.  
Blockpaving for driveways.  
Asphalt driveways.  
Slabs for patios supplied and laid.

**Rackheath Paving & Fencing**

Tel: 01603 721270

Mobile **07795363955**

rackheathpavingandfencing@gmail.com



Long established company offering friendly, professional cleaning services:

- Windows
- Conservatories
- Fascia/boards
- Guttering
- Solar panels



**KEV 07786 254 831**  
**RICK 07377 678 801**

mywindowcleaner@email.com  
www.mywindowcleanersnorwich.co.uk

*"We'll get those windows sparkling!"*

## C & N CONSTRUCTION

(BUILDING SERVICES)  
UPPER ST SALHOUSE

EXTENSIONS, LOFT CONVERSIONS  
ALL RENOVATION WORK  
RE- ROOFING  
ALL CARPENTRY WORK  
KITCHENS & BATHROOMS  
PLASTERING

WALL & FLOOR TILING (Ceramic, Slate, & Natural Stone)

All work carried out to a very high standard

Offering a Friendly & Reliable Service

Tel (01603) 722985

Mob: 07832 108991

**www.cn-construction.co.uk**

# J Gedge & Sons

*Independent Family Funeral Directors*

*24 Hour Personal Service*



01603 712276

[www.jgedgeandsons.co.uk](http://www.jgedgeandsons.co.uk)



Zoë Bidwell  
Bespoke Flowers

Flowers for gifts, events,  
weddings and funerals

Plants, homewares, gifts and  
garden accessories available  
instore

[bespokeflowers.uk](http://bespokeflowers.uk)  
[info@bespokeflowers.uk](mailto:info@bespokeflowers.uk)  
01603 343988  
Black Barn Farm, Norwich  
Road, Salhouse, Norwich,  
NR13 6QG

BLACK  
BARN  
FARM

Geoff's  
Plumbing

City & Guilds Qualified

Insured

No Job Too Small

Geoff 01493 701603

or 07880 605516

[geoff.sayers@gmail.com](mailto:geoff.sayers@gmail.com)





**Friendly, local domestic and commercial flooring company.**

**Carpets, Vinyl's, Luxury Vinyl Tiles, leading brands including Karndean, Amtico, Cormar and Brintons plus many more.**

**Wide range of samples to view in our showroom or in your own home.**



**For advice or a free no obligation quote please call 01603 720164.**

**Wood Green Industrial Estate, Station Road, Salhouse, Norwich, NR13 6NY**

**Email: [office@broadlandflooring.co.uk](mailto:office@broadlandflooring.co.uk) [www.broadlandflooring.co.uk](http://www.broadlandflooring.co.uk)**



*Looking out for you*



*"I believe in treating people how I would want to be treated myself. This means there are no silly questions and I am always available to talk things through"* Leigh Reeves MNAEA



*"I've always found over the years, that by taking time to listen and really understand what my clients want, I can help them through their challenging journey."* Paul Sullivan MNAEA

## location, location, location

Conveniently located at the busy Sainsburys supermarket on Pound Lane in Thorpe St Andrew, Morton Reeves are independent estate agents with over 75 years of local property experience.

Our team will hand craft a bespoke marketing strategy that will reflect how your property should be marketed to get the very best result for you. Our highly recommended personal service will then walk you through the transaction from start to finish.



**MORTON REEVES**

*Local Independent Estate Agents*

The Dussindale Centre (Next to Sainsburys)  
Pound Lane, Thorpe St Andrew, Norwich, NR7 0SR

T: 01603 432000 [www.mortonreeves.co.uk](http://www.mortonreeves.co.uk)

- Experienced
- Professional
- Highly recommended

rightmove



## WROXHAM AND HOVETON LIONS



The nights are drawing out and Spring is nearly here. At the end of February, members and guests attended the Club's 47th annual Charter Dinner at the Hotel Wroxham. Only 3 years to go until we reach the milestone of our half century of serving the community, by helping deserving causes and those less fortunate. We are so grateful for all the support from the residents in our area, so a big thank you to all those who have donated to our fundraising activities.

Our first fund raising event for 2023 is a CRAFT FAIR being held on Sunday 12th March at the Broadland Youth and Community Centre Stalham Road Hoveton. From 10am to 3pm. Admission is free and refreshments are available. So why not come along and see the wide variety of local crafts available, all at reasonable prices, with something for everyone.

The Club has recently purchased 3 generators, which are being sent to Ukraine to help families who have no power. In total 110 generators are being taken there by a party of volunteers. Additionally, we have also sent a donation to our International Foundation to help with supporting the people of Turkey and Syria in the aftermath of the horrendous earthquake there.

A date for your diaries - Our annual summer CHARITY VILLAGE FETE this year, is being held on Sunday August 6th at Hoveton Village Hall and Playing Field. 10am to 4pm. Bookings for all pitches (including Craft pitches both inside the hall and outside), as well as Classic vehicles, are now being taken. However, availability of inside pitches is now very limited. Forms can be downloaded by going to our website: [www.wroxhamandhovetonlions.org](http://www.wroxhamandhovetonlions.org) and clicking on the link "Fundraising Events" or alternatively by telephoning Lion Mike Clipston on 07767810027.



Our charity shop continues to be busy and we still need your donations of good, clean items, especially bric-a-brac, so If you are having a sort out, or down-sizing, please bear us in mind. You can drop items in at the shop, or alternatively ring them on 01603 783737 or myself on 07850091570 and we can arrange collection. We would respectfully ask anyone donating clothing to our charity shop, to please make sure that they are clean and in a saleable condition.

We always welcome new members, so if you have any spare time and feel you would like to put it to good use and give something back into your community, why not think about joining us. If you are interested, please give me a call 07850091570 or contact our membership chairperson, Lion Lydia Spight, via our “Learn More” link on web site [www.wroxhamandhovetonlions.org](http://www.wroxhamandhovetonlions.org).

**Lion Terry Vout**

President.

<b>OPEN GARDENS FOR ST. JOHN AMBULANCE 2023</b>		
<i>Home-made Refreshments (HMR) and Plant Sales (PS)</i>		
<a href="mailto:stjohnpengardensgmail.weebly.com">stjohnpengardensgmail.weebly.com</a>		
<b>Sunday 5th March</b> CHESTNUT FARM, HMR & PS West Beckham, Holt, NR25 6NX Adults £5, children free.	Open 11:00 - 4:00pm Dogs on leads welcome	<b>Sunday 11th June</b> BESTHORPE HALL, HMR Attleborough, NR17 2LJ Adults £5, children free.
<b>Sunday 2nd April</b> GAYTON HALL, HMR Gayton, King's Lynn, PE32 1PL Adults £5, children free.	Open 12:00 - 5:00pm Dogs on leads welcome	<b>Sunday 25th June</b> SEVERALS GRANGE, HMR Wood Norton, Fakenham, NR20 5BL Adults £5, children free.
<b>Sunday 7th May</b> BECK FARM, HMR The Green, Brisley, NR20 5LN Adults £5, children free.	Open 12:00 - 5:00pm Guide dogs only	<b>Sunday 2nd July</b> SALLE PARK GARDENS, HMR & PS Salle, Reepham, NR10 4SF Adults £5, children free.
		<b>Sunday 1st October</b> CHESTNUT FARM, HMR & PS West Beckham, Holt NR25 6NX Adults £5, children free.
		Open 11:00 - 4:00pm Dogs on leads welcome



## 1st Salhouse Beavers & Cubs

This term Beavers have enjoyed learning about Chinese New Year, making lanterns and practicing their skills with chop sticks. We also had fun learning how to do some scouting basic skills, such as knotting and building bridges out of paper.

We are looking forward to learning about how things grow and a trip to the local woods in the coming weeks.

We currently have 18 Beavers and run a waiting list. If your child is interested in joining our group, please contact us for more details.

Our Cub Pack returned in the New Year taking a look at the Chinese culture and festivals. Their task was to make a large dragon, so with cardboard boxes, brightly coloured paper and streamers, the Cubs worked together and made a dancing dragon, then had fun making it dance to their own music.

Following on from China, we proceeded to visit Italy, India and Mexico looking at Scouting and their cultures as well as sampling the different cuisines, all prepared by the Cubs. They made ice cream, snakes from bottle tops and worry dolls too. A busy few weeks but very enjoyable.

On Wednesday 22nd of February, we were able to celebrate Robert Baden Powell's birthday, the founder of Scouting, on the actual day with youngsters from Scouting and Guiding wearing their uniforms to School.

The Cubs had a visit from Baden Powell during their Pack Night who tested their knowledge of Scouting and assisted the Cubs in making a membership badge. A memorable night to remember as Cubs can now picture what this famous person looked like.

Future Events for Cubs include our annual St George's Day Parade on the 23<sup>rd</sup> April at Buxton and the Annual JOTT (Jamboree on The Trail) in May, where Scouts everywhere in the world all hike together, on the same day.

With the light nights just around the corner we are all looking forward to getting back to the woods and practicing our fire lighting, backwoods cooking and shelter building, to name but a few activities.

We have waiting lists in all our three sections, Beavers, Cubs and Scouts and are always looking for adults who could maybe help out in Scouting by becoming assistants or leaders.

If anyone would like to come along to a section meeting on a Wednesday or Thursday evening, please give me a ring and we can have a chat and arrange for you to come along and see what is involved, with no commitment.

We are currently looking at fulfilling a dream we have had at 1<sup>st</sup> Salhouse Scout Group for many years and having our own Scout Hut and premises. This has recently been made possible through opportunities for groups to apply for large grants for refurbishments of old Scout huts or even the building of new scouting premises.

If anyone knows of any suitable land we could build a new Scout hut on, in Salhouse or Rackheath then please get in touch, we would be open to any suggestions as we need somewhere to build a hut before we can apply for the grant.

**Jackie Rose - Cub Leader & Group Scout Leader - Tel 07780 604707**

**Email as below**

Any Beaver enquiries to Tracey Hayton - [1stsalhousebeavers@gmx.co.uk](mailto:1stsalhousebeavers@gmx.co.uk)

Cub enquiries and general Scouting enquiries to [jackierose@talktalk.net](mailto:jackierose@talktalk.net)



Our sleepover last term at High altitude was a great success, girls enjoyed bouncing on the trampolines and playing games such as dodgeball. They then got cosy in the sleeping bags and settled down on the trampoline to watch a film. They were up again early in the morning for another bounce before heading home, it was a fun yet chilly evening!

We spent December meetings enjoying Christmas crafts, finishing the term with a joint trip to the cinema with 1<sup>st</sup> Salhouse Brownies and 1<sup>st</sup> Salhouse Rainbows to see Matilda, as there was 50+ of us we were lucky to have a screen to ourselves. The girls really enjoyed the film although there were several trips to the toilets!!

This term we have been working on our space badge looking at the star constellations and learning about the planets in our solar system.

February saw us joining over 100 members from the district for our Thinking Day celebration, these events are a great opportunity for the girls to get together with other units to make new friends, meet the girls who will be Brownies soon and greet old ones that are now Guides.

We are currently looking forward to our Easter sleepover where we will be exploring the local area. We will be heading to Cromer for a Brownie weekend in June too.

**Natalie**

If you would like to find more out about joining Brownies, then please contact Natalie on 07500 060818 or email [2ndsalhousebrownies@gmail.com](mailto:2ndsalhousebrownies@gmail.com) or you can register your interest at <https://www.girlguiding.org.uk/joinus>



Salhouse Rainbows had a busy winter as usual!

We finished 2022 with a camping theme, building tent forts, doing kitchen-less cooking, singing campfire songs (complete with sign language) and playing games to help us think about what we need to take camping and how to protect the natural world. We also enjoyed plenty of Christmas activities including the district Christmas disco, a trip to see Matilda at the cinema and making Christmas treats.

Since Christmas we have been joined by three new rainbows. In our meetings we have been focusing on the theme of 'networks' which is all about developing relationships with family and friends and being confident to express yourself.

We have learnt about different types of relationships, shared our opinions and jokes, been brave enough to perform in front of our friends, worked as a team to build robots and musical instruments out of junk, made Valentine's Day biscuits for our loved ones and generally had lots of fun.

We also celebrated Thinking Day 2023 in February, joining with the rest of the Hautbois district for an afternoon of activities with the theme of 'our peaceful future'. We did lots of creating, got messy, and (ironically) made lots of noise.

In January we were thrilled to welcome a new unit helper, Celia, as well as a new young unit helper, Mirabelle. This is particularly good news as Naomi, my fellow unit leader, will be taking a break from Rainbows to have a baby. We are all excited for her but will miss her very much.

*salhouserainbows1@gmail.com.*

**Helen**

This update from 1<sup>st</sup> Salhouse Scouts comes to you from the Scouts themselves. We are aiming to get the Scouts more involved in the community and promoting what they do within the group. So here they are in their own words updating you on what we've been up to...

**Hobbies Talks.** We split into our patrols to talk about our individual hobbies to help build our confidence, these hobbies included moto cross, sea glass collecting (Fossils, seaglass and crystals) and Warhammer. We liked it because we could share our hobbies with our patrol.

**Model Making.** Everyone started with two unbuilt model warhammers. We cut them out, we put them together and painted them in our own style. We liked it because we could paint it our own style.

**Josh Hill, Seth Blackburn-Cann, Ted Tibbenham**

**Boil in the Bag.** What we did is we had ration packs and there was various meals in them. To cook them we filled up a pot of water we put to a boil on the stove then we opened the top of the bag then we put the bag in the water till it cooked then we ate it.

**Chinese Cooking and Craft.** For the cooking part we did a rabbit stir fry which was spicy. For the craft we made money pouches which was filled with sweets inside to celebrate Chinese new year.

**Cooking Competition.** We entered the district cooking competition at North Walsham in the half term break. We had a budget of £15 and we had to cook a 3 course meal. We were in teams of 4 without any help from the Scout Leaders. The first team consisted of Harry, Ten, Ben, Flynn, they cooked; Prawn cocktail, sausage and mash and then eat and mess. The second team consisted of Ryan, Lian, Morgan and Matthew and we cooked; warm pigeon salad, pork and apple burgers and then pancakes. And we won the competition and won a trophy.

**Ryan Seaman, Liam O'Kane, Harry Spaul**

Last half term, we made wooden chairs, but in order to be safe whilst making the wooden chairs we needed to learn first aid. We started off the

night learning how to treat burns, then when someone has hypothermia you put a reflective blanket on them so they heat up quick and we learnt how to treat head injuries, cuts and lots of other wounds. For DIY where we cut pieces of wood to create a chair after measuring and the equipment used was drills, saws and rulers. We had to use the pieces of wood to construct the chair with drilling holes into the wood and screwing them together.

**Adam Houston, Sebastian Jenkins, Corey Carpenter**

In the last 5 months, Scouts have participated in 3 community projects. One of these projects was building a bug hotel in Newman Woods in Rackheath. We started by placing layers of old bricks, fallen sticks, leaves, tiles and some rocks. While others built up the main section a few people made the roof using planks of wood and some screws. It can be seen past the first blast shelter from World War 2 standing proud.

Another activity we did was bulb planting on Bell Lane in Salhouse near the Church. There were at least 6 Scouts plus Beavers and Cubs. It lasted 2 hours but there were some delays because the ground was frozen solid! The bulbs have just come up so take a look, it looks amazing!

The last activity was tree planting in Rackheath on Stracey playing field. We planted 100 plus trees swiftly, we worked well as a team and enjoyed the morning.

**Rebecca Hill, Alex Dove**

One evening last term we visited another Scout group, 15<sup>th</sup> Norwich Scout Group. We were split up into groups, one group would shoot while the others had to make a fire to burn a bit of string through. We really enjoyed this event gaining confidence in our fire building and knowledge in using air rifles safely.

**Jacob Green**

At North Walsham Scout hut last term we did a district run around quiz with North Walsham Scout Group. There were various options A, B, C, D and a no answer section if you thought the answer wasn't A, B, C or D. There was also different rounds like the Simpsons and Marvel. I enjoyed this as our team won and it was a good afternoon.

**Morgan Scotton**

One evening last term we visited 15<sup>th</sup> Norwich Explorer Scouts and while we were there we had a go at shooting and we made fires as big as we could to burn some rope. When we shot targets the other group made fires. When we shot we were in groups of four at a time, we used air rifles and we wore goggles for protection, once we shot we waited for everyone to finish then we collected our target then it was the other fours then, we

repeated it about two or three times, we gave our targets for the end where we would find out who got the highest score. After we shot we were outside to swap with the other group of eight and made fires. The aim of the game was to make your fire the biggest so it burnt through a string. That was our day at 15<sup>th</sup> Norwich Explorer Scouts. **Matthew Guin** Remembrance Craft. All of the Scouts make poppies to put on a remembrance wreath ready to march up to the church and place it at a remembrance memorial. The wreath is actually still there now! Some other people make poppy wreaths as well.

Remembrance March. All the Scouts who wanted to participate met up in the Bell car park to walk up to the church and place the poppy wreath and enjoy the remembrance service together reflecting on the war.

Night Hike. The Scouts met up at Lingwood village hall when it was 1°C and we had to walk to Strumpshaw. We had fun because we were talking and playing throughout the walk. We also visited a church and had a break when Toby realised he lost his gloves! Then we walked back to the hall.

**William Keys-Baston, Ben Sewell, Marley Nye**

Despite being an active group for over 50 years, we still do not have our own Scout Hut and grounds. If you know of any land that may be suitable for us to look at building a hut of our own please get in touch!

We meet on Thursdays, 18:30 – 20:30, Scouts are 10.5 to 14 years old. Would you like to join us in the future? Feel free to get in touch and join the waiting list.

### **Simon Hill – Scout Leader**

Al Spaul – Assistant Scout Leader

Trevor Wicks - Section Assistant

Shelly Seaman - Section Assistant

Rose Ottaway – Young Leader

salhousescouttroupe@gmail.com

-----



Affordable prices  
with a professional finish

## SPENCER HOLMES

RACKHEATH, NORWICH

T: 01603 722548

M: 07507 233181

E: SPENE45@GOOGLEMAIL.COM



HOLMES  
GARDEN SERVICES

# Claire Carney



## Floral & Balloon Designs

claire@clairesfloralandballoondesigns.co.uk • 07591 524348

www.clairesfloralandballoondesigns.co.uk

**Stunning flowers and balloons for all occasions!  
Call, text or email to discuss your requirements.**



Based in Salhouse with delivery available  
across Norfolk.

Eco options available for both flowers and  
balloons.





## Spring at Salhouse Garden Centre...

- **Flowers** - A wonderful selection of quality primroses in a glorious array of colours plus planted up bowls, pots and house plants
- **Bedding Plants** - Our spring bedding plants will be here from late March onwards
- **Seeds & Bulbs** - Seed potatoes, veg and salad seeds, summer flowering bulbs
- **Gift Shop** - Our Gift Shop is open to browse for Cards & Gifts



Honeycombe Road, Salhouse, Norwich, NR13 6JP  
01603 722250 | [www.salhousegardencentre.co.uk](http://www.salhousegardencentre.co.uk)

# Salhouse Jubilee Hall ‘At the Heart of your Community’

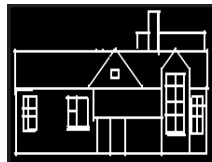

As I sit here writing this article it definitely feels like Spring has arrived in Salhouse, seeing the snowdrops and daffodils out, and even the sun making an appearance from time to time, it seems like a good time to reflect on last year.

Despite having a challenging start to last year, with the Omicron variant still around (I hope that is the last time I make any reference to Covid in an article), we saw the Hall quickly get back to some sort of normality with both regular and adhoc users coming back to the hall. We were busy again! This meant we were able to completely redecorate the interior of the hall and make a number of repairs/replacements to the external woodwork and windows, where large sections had rotted away. All woodwork was then sanded and repainted. Thank you to all those that carried out the work for us.

We were also able to hold a couple of key events last year. Firstly, to celebrate the Queens Platinum Jubilee, we held a party in the (car) park style event. Thank you to those that came and supported us. We also held our first Christmas Fayre in three years. We ran a slightly different format this year spreading stalls out over both halls to try and create less congestion and more atmosphere, which judging by feedback seemed to work really well. It was also nice to meet a number of new people who have moved into the village over the last two years at the Fayre, we hope you enjoyed the event. We had a record year both in terms of numbers attending and money raised towards the upkeep of the hall so thank you all for your support.

Looking forward to this year, the Hall looks to be in a good place, with a good number of clubs and groups using it. I would also like to extend a special welcome to the hall to Zumba, who meet on a Thursday morning, and the Red Loft Theatre Group who along with the Broadland Choir meet on a Friday evening. If you have need for a hall, either on a regular basis, or for a one-off booking, please get in touch with Pat on the number below.

Finally, following Sue’s decision to leave the committee, as reported in the last issue of the Saga, I would like to thank Natalie for taking on the role of treasurer, a vital role which needed to be filled for the Hall to continue to function. I would also like to thank all the committee for their combined hard work in keeping the hall functioning and looking so good.

**Martin Carney** Chairman – Salhouse Village Hall Committee Tel: 07808 097924

**If you would like to book the hall, then please call Pat, tel: 01603 720466**

## Local Football News



### Salhouse Rovers Under 7's

It's been a busy season so far for the under 7's team. We have been playing in the under 7's league for the first time and have improved so much. The change from the teams first match in September to now is astonishing and the team has grown in confidence. We have won 2 friendlies and drew in a league game, and each match we play our passes and tackling are getting better and better.

The league matches will finish in April, but we have got friendlies lined up for the summer and hoping to play in our first football tournament in June.

We have also expanded our team and have recruited new players. The new players have fitted in well, and the children seem to be really enjoying playing the matches and working together as a team. The children's enjoyment continues to be our top priority.

We would also like to say a big thanks to coaches Paul, Kevin and George, the children and parents really appreciate all that you do.

**Jodie Wardle**

email [Jodie.wardle1980@gmail.com](mailto:Jodie.wardle1980@gmail.com)

# *Salhouse Rovers Football Club*

Searching for players for Under 8s (year 3) team

Training Mondays 1730 to 1830 in Salhouse, Thieves Lane Recreation Ground

£2 per session (Under 6s year 1 have a separate training at the same location / time)

Open to Boys or Girls

Offering friendlies games on some Saturday Mornings

League games subject to team selection – (some additional fees required)



Contact Adrian Willis – qualified Football Coach with 1<sup>st</sup> Aid Qualification, Safeguarding and DBS  
on 07720670655 / [adrian\\_willis@hotmail.co.uk](mailto:adrian_willis@hotmail.co.uk) if interested

# Salhouse Tree Steward



Spring. Leaf buds are bursting into life and the blackthorn stands out with the first blossom of the year. The birds strengthen their morning chorus as the sun greets them earlier and earlier. Spring, full of potential for the year ahead.

Winter 22/23 planting was successful. The nursery gave out around 900 trees & shrubs. Amazing volunteers helped plant 170m of hedgerow and 20 field trees in Salhouse, and the 1<sup>st</sup> Salhouse Scout Group and many volunteers helped plant 250 trees and shrubs at Rackheath Pavilion with astonishing force and effectiveness. Well done!

The nursery will continue to grow stock to give out winter 23/24. Please contact me if you are thinking of planting.

Thanks to the following who have supported our endeavours over the last year, with generous help of volunteers, land and support from Black Barn Farm, funding from Norfolk County Council and Broadland District Council and Rackheath Parish Council for inviting tree planting on their Sports Field.

If you would like to volunteer at the Nursery or plant trees next winter drop me an email.

**James Cleaver**

Salhouse Tree Steward

[Salhousecommunitytreenursery@gmail.com](mailto:Salhousecommunitytreenursery@gmail.com)

Facebook page: @salhousecommunitytreenursery

# AFTERNOON TEA AND MARDLE



## Meet the Mardlers!

**An inclusive group for men and women of all ages**

**At the Jubilee Hall every 2nd Wednesday of the month  
between 2 and 4pm**

A social chat, a cup of tea or coffee and home-made cake.  
Opportunity to meet new friends. Plus a raffle and a quiz!!

Thanks to all our volunteers, especially those who donate home-made  
cakes, scones, and sausage rolls.

## ALL WELCOME!

### SPRING 2023 DATES:

April 12th

May 10th,

June 14th

July 12th

**For further information please contact:**

**Julie on 720049 or Doreen on 721229**

# Salhouse & District Gardening Club



First, a correction to the notes in the Winter 2022 edition of Saga. As members will know, we always meet on the **third** Tuesday of every month and not the second as incorrectly stated. Fortunately the remaining programme with correct dates was also included so no harm done. Apologies for the error.

We have now completed the arrangements for the year 2023 / 2024. Thanks to Margaret for all the work involved in putting together a varied and interesting programme.

The details are below:

## 2023

March 21st	Bees in our Garden	(speaker tbc)
April 18th	Hostas	Ken Able
May 16th	Gardens Open to the Public	Rosie Ward
June 20th	Day trip to Sandringham Gardens followed by a stop at West Acre.	
July 18th	Evening visit to Swafield Hall Gardens with refreshments.	
August 15th	Evening visit to Blickling Lodge Gardens with refreshments.	
Sept 19th	Bugs: Cohabit and Control	Dr Ian Bedford
Oct 17th	Flowers in Photography	Liz Fiddy
Nov 21st	Botanical Gardens	Jim Paine
Dec 19th	Christmas Party	

## 2024

January 16th	Small Trees and Shrubs	Andrew Turff
February 20th	Flowers of Norfolk	Simon Harrap
March 19th	Sissinghurst—More than a White Garden	Andrew Sankey



As in previous years our June, July and August meetings will be away from Woodbastwick Village Hall, with our day trip in June. We aim to give full details at our March meeting.

We have been pleased to have had some new members join us since our last report. If anyone is thinking of joining us, why not come along to one of our meetings and give it a try? We will make sure you are made welcome.

For more information about the Gardening Club please contact Nick Taylor (01603 720165) **Nick Taylor - Chairman**

### **KEY'S BRAINBUSTER QUIZ – ANSWERS - ACRONYMS**

1. Plug-in Hybrid Electric Vehicle
2. Ultra Heat Temperature
3. Magnetic Resonance Imaging
4. International Whaling Commission
5. Anti-Social Behaviour Order
6. Buildings Antenna Spans Earth
7. Radio Detection and Ranging
8. Graphics Interchange Format
9. United Nations Educational Scientific and Cultural Organisation
10. Self Contained Underwater Breathing Apparatus
11. British Academy of Film and Television Arts
12. British Board of Film Classification
13. Personal Identification Number
14. Acquired ImmunoDeficiency Syndrome
15. Organisation of Petroleum Exporting Countries
16. Government Communications Headquarters
17. United Nations International Children's Emergency Fund
18. Portable Document Format
19. You Only Live Once
20. Automated Teller Machine

# Spring is around the Corner...



We have now slipped into March, and I must say I am pleased to see the sunshine out, although I did still have to de-ice my car the other day! It's pleasing to see that the evenings are lighter and metrological Spring will be upon us on the 20th March.

## **How is the property market doing?**

From a lending perspective I feel that there is less uncertainty moving forward and although the Bank of England did increase rates last month, we have seen some lenders starting to soften their position and offering deals that make borrowing slightly more attainable.

On the whole, we are finding that prospective buyers who are viewing properties at this time have reset their expectations with regards to borrowing and know the implications if interest rates were to rise, or if they have already done so since their search began.

This means that there are no awkward shocks for purchasers when they start analysing what their monthly outgoings will be upon making an offer!

Property values have fallen since the height of the market midway through last year, the correction in the market appears to be at least 5% and, in some cases, higher.

Taking a step back from the whole situation... Yes, undoubtedly interest rates are higher than they have been for many years although I can remember buying my first home and the mortgage rate then even allowing for a low start rate it was still at a frightening 15%, but let's face it even with the increased rates, mortgages today are still very competitive and what's the alternative to rent! With rental prices surging and available property diminishing, that potential avenue is becoming more difficult to navigate every day!

## **So, what do I expect moving forward this year?**

We certainly feel that taking a balanced view on all of the information to hand that the Spring market will kick in as usual.

So, as we move towards April, valuation levels have increased dramatically, viewing levels will increase still further... we are already experiencing more offers coming in on properties!

In fact, we actually had successful sales months in January and February! So, we are already up and running!!! We expect more moving forward and to put a comparison to the marketplace, I anticipate that we will go back to a marketplace similar to what we were experiencing in mid-2019. Which is a stable period of consolidation, and this will give things a bit more of a chance to settle down.

The good news is we would expect that with the increased levels of buyers and sellers returning to the market for Spring, lending products become more affordable. This will bolster the housing market although we don't expect that house prices will rise anytime soon, more likely they will run flat through this year and potentially rise next year if the economic conditions are right.

Clearly as we said earlier, consolidation is key for housing to recover to allow some buyers priced out of the market to return.

Given the dizzy heights of the post covid lockdown market where a 10% increase was the yearly norm, which of course was always going to be unsustainable year on year in the long term, and regardless of that traumatic Autumn budget of last year allied sadly to the war in Ukraine/cost of living rises which fuelled an economic and market slowdown, it was ironically always likely we would have seen the property market slow down naturally towards the end of last year.

Regardless of what went on before, the property market at least looks set to be settled over the rest of this year, with a greater number of available stock of property for sale and settled house prices, so it would appear for those wishing to move or buy their first home it will be a very good time to do so....

If you would like to discuss any elements of this piece or have questions relating to property that you would like help with, then please do not hesitate to contact us on **01603 432000**.

Find out more about us at <https://www.mortonreeves.co.uk/> on which we even have an online property valuation tool that will give you an approximate indication in 20 seconds for your home. We also have several online video tips and guides for various aspects of selling or buying a property which have proved useful to the first-time buyer or indeed the seasoned buyer or seller.

**Paul Sullivan**

Morton Reeves Estate Agents





# ClearView

## Financial Consultants Ltd

1 Burgh Road, Aylsham, Norfolk, 01263 734859  
Station Road, Hoveton, Norfolk, 01603 273590

*An unbiased, whole of market service, offering tailored & accountable advice.*

- *Investment Planning & Reviews*
- *Inheritance Tax / Wealth Preservation*
- *Care Cost Advice*
- *Personal Protection Policies*
- *Pensions & Retirement Options*

**Home visits for your convenience**

Registered in England & Wales under Company Number 9259999. ClearView Financial Consultants Ltd is authorised and regulated by the Financial Conduct Authority under number 672601

## MIKE SPANTON

# Plant Hire Contractor

Est. 1984

Based in Salhouse Tel. 07768 803805



*Friendly, reliable and competitive service*

- Foundations / oversite
- Driveways
- Drainage
- Treatment Plants
- Site Clearance
- Delivery of screened top soil, crushed hardcore, crushed concrete, crushed asphalt
- Shingle of various sizes

**26 ton gross Beavertail Plant Lorry and Driver available for hire**

Contact Mike on **07768 803805 / 01603 819088**  
Email - **spantonmichael1@gmail.com**

# Wroxham Heating Ltd

## John Middleton

### Gas Heating Services

01603 782542 07765671117

[www.wroxhamheating.co.uk](http://www.wroxhamheating.co.uk)  
[john@wroxhamheating.co.uk](mailto:john@wroxhamheating.co.uk)

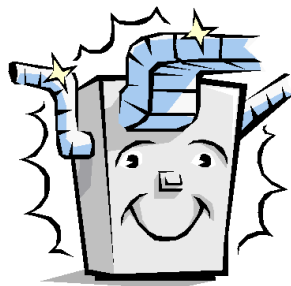

**Gas Safe Registered**  
210650

**City and Guilds Qualified**  
**Gas Service Engineer**

**British Gas Trained**

**Friendly, Reliable and**  
**Prompt**

**Local Service**

**30 years experience**



### **Servicing**

Servicing all types of Domestic  
Gas Central Heating, Fires,  
Cookers and Water heaters  
Warm Air Units

### **Maintenance**

Repairs to gas Appliances.  
Large range of spare parts carried  
Landlords Inspections  
Unvented Hot Water

### **Installation**

All Types of Domestic  
Gas Heating  
Unvented Hot Water

### **Sludge and Scale Removal** (Power Flushing)

If you have a Noisy Heating  
System a Power Flush could be  
the answer to reduce noise and  
increase efficiency

Supported by



East of England Ambulance Service **NHS**  
NHS Trust

## **EMERGENCY DEFIBRILLATOR (AED) INSTRUCTIONS FOR USE**

In the event of a suspected heart attack / chest pains, the following procedure should be used:

1. Call **999** and ask for the Ambulance Service
2. Tell the Operator the telephone number from where you are calling, and they will tell you the location of the nearest Cabinet, as follows:

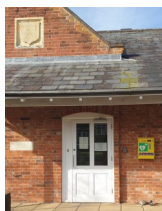

Jubilee Hall, Lower  
Street Salhouse  
NR13 6RE



The Green,  
Lower Street,  
Salhouse  
NR13 6RY



Station Road  
Salhouse  
NR13 6NX



The Recreation Ground  
Thieves Lane, Salhouse  
NR13 6RQ

3. The Operator will ask a series of questions which you need to answer to the best of your ability. This will only take a few seconds and will not delay the Ambulance.
4. THE OPERATOR WILL THEN PROVIDE YOU WITH THE ACCESS CODE TO OPEN THE CABINET
5. The Defibrillator and Resuscitation Pack should be removed from the cabinet and the Ambulance Service will stay on the line and give verbal assistance if required.
6. Switch on the Defibrillator and IT WILL GIVE YOU VERBAL INSTRUCTIONS FOR USE.
7. The Defibrillator cannot be used incorrectly as it will only deliver a shock to the patient if it detects it is necessary.
8. There are scissors in the Resuscitation Pack to assist with the removal of clothing and a pocket rescue breath mask to carry out CPR.

### **REMEMBER – Think SAFETY**

Before pushing the button, make sure everyone is clear and shout:

**“STAND CLEAR - SHOCKING”**

## Speedwatch seeks Volunteers



Norfolk Police aim to reduce accidents and deaths on our roads and in doing so, in conjunction with the Safety Camera Partnership, have empowered Community Speedwatch. This service enables villages to conduct formalised monitoring of vehicle speeds to maintain road safety.

Salhouse has participated in this service since 2008 by conducting observations at approved locations within the parish. This is based on a group of trained volunteers observing traffic at

random times to monitor traffic speeds and record those over proscribed limits.

With this service we hope to keep our village roads a safer place for all.

To achieve an effective service we need additional volunteers and would ask that if you can spare an hour or so per month to assist please contact

Malcolm Prestwood on 01603 721110 or Steve Piper on 01603 720993

### Answers to Team Salhouse Wordsearch:

BELAUGH	HOVETON	SALHOUSE
BLOFIELD	LAMAS	STALHAM
BRUNDALL	LINGWOOD	STOKESBY
BUCKENHAM	LUDHAM	STRUMPSHAW
BUXTON	PLUMSTEAD	SURLINGHAM
COLTISHALL	POSTWICK	UPTON
DILHAM	RACKHEATH	WOODBASTWICK
HORNING	RANWORTH	WROXHAM

# MILL KENNELS

Proprietor Rachel Burdett

**OPEN ALL YEAR ROUND  
ONLY FULLY VACCINATED DOGS ACCEPTED  
INDIVIDUAL DIETS CATERED FOR  
MEDICATION GIVEN AT NO EXTRA CHARGE**

E-mail: [carozza1@live.co.uk](mailto:carozza1@live.co.uk)

Mobile: 07766101009

Kennels: 01603 720592



## Platten Pest Control

*Rats, Mice, Wasps,  
Moles, Rabbits etc:*

*Wasps' Nests Destroyed -*

**FREE SURVEY  
24 HOUR SERVICE AVAILABLE**

**Tel: 01692 631173**

**Fax: As above**

**Mobile: 07711 391839**

## GEORDIE'S WINDOW CLEANING SERVICE

***GUTTERS, FASCIAS &  
SOFFITS CLEANED***

**YOUR LOCAL  
FRIENDLY  
SERVICE**

**20 NORWICH ROAD SALHOUSE**

Phone for a quotation on:-

**01603 721402 or**

**Mob: 07768 428274**



## **NEED HELP? Useful Contacts List:**

**Broadland District Council Help Hub** - for help with obtaining basic essentials, Covid-19 help, money worries, isolation or loneliness, relationships, domestic issues - 01603 430431 also [helphub@broadland.gov.uk](mailto:helphub@broadland.gov.uk)

**Salhouse United Charities**—Financial assistance available to Salhouse residents in crisis. Call 01603 721201 in confidence.

**Business Support** - if you or your business requires any Covid-19 support - 01603 980441 or [business@broadland.gov.uk](mailto:business@broadland.gov.uk)

**Salhouse Good Neighbours Scheme** - 07856 989351 or [clg7317@gmail.com](mailto:clg7317@gmail.com) - village support to those without other means of assistance. Covid safeguards followed.

**Carers Matters Norfolk** - <https://carersmatternorfolk.org.uk> - 0800 083 1148 (Mon-Fri 9am to 8pm; Saturday 10am to 2pm; Sunday 10am to 2pm). For those with caring responsibilities.

**Age UK Norfolk** - telephone befriending and support for older people and their carers. 01603 787 111 - or phone advice line on 0300 500 1217 (Monday-Friday 10am to 4pm) or email [advice@ageuknorfolk.org.uk](mailto:advice@ageuknorfolk.org.uk) . See website: [ageuk.org.uk/norfolk](http://ageuk.org.uk/norfolk)

**Samaritans** - there for you, whatever you're going through. Call free on 116 123 or email [jo@samaritans.org](mailto:jo@samaritans.org) to receive a response within 24 hours. Letter writing and self-help app service also available.

**You Are Not Alone (YANA)** - support for those in farming or rural businesses. Call helpline 0300 323 0400 for confidential support or email [help-line@yanahelp.org](mailto:help-line@yanahelp.org) . See also <https://www.yanahelp.org>

**Checkatrade** - for a trusted tradesperson - <https://www.checkatrade.com>

**MIND** - mental health support - 0300 123 3393 or email [info@mind.org.uk](mailto:info@mind.org.uk) or text 86463. Info line provides an information and signposting service. Open 9am to 6pm, Monday to Friday (except for bank holidays).

**SANE** - support for people with mental health problems, their families and carers. Text or leave a message on 07984 967 708 or email [support@sane.org.uk](mailto:support@sane.org.uk) See [sane.org.uk](http://sane.org.uk) for Support Forum.

**BEAT** eating disorders - see [eatingdisorders.org.uk](http://eatingdisorders.org.uk) - helpline: 0808 801 0677 / studentline: 0808 801 0811 / youthline: 0808 801 0711 - 365 days a year 9am to 8pm weekdays and 4pm-8pm weekends and bank holidays. One-to-one webchat also available.

**BullyingUK** - support against bullying for children and adults - 0808 800 2222 or [bullying.co.uk](http://bullying.co.uk)

**Switchboard LGBT+ Helpline** - 0300 330 0630 - 10:00 - 22:00 every day or email [chris@switchboard.lgbt](mailto:chris@switchboard.lgbt) . Webchat available daytimes.

**The Bridge Plus+** - support for black and minority ethnic (BME) communities in Norfolk - 01603 617076 / 07717 220209 Monday-Thursday 10am-3pm or email [office@bridgeplus.org.uk](mailto:office@bridgeplus.org.uk)

# Advertisers Index

## ARCHITECTS

Broadland Architects----- 25

## BUILDERS & CONSTRUCTION

J Newton Groundworks ----- 28

C&N Construction ----- 50

Mike Spanton-Plant Hire----- 74

## DENTISTS

Dental Care Clinic ----- Inner Front

## DOMESTIC/REPAIRS & SERVICES

Andrew Brierton, Appliance Repairs- 31

## ELECTRICAL

Critten Electrical ----- 28

## EMPLOYMENT VACANCIES

Allcare Community Support ----- 39

## ESTATE AGENTS

Morton Reeves----- 53

## FINANCIAL SERVICES

Clear View Financial Services ----- 74

## FITNESS

Fitness at The Street----- 37

## FLORISTS

Bespoke Flowers -----51

## FUNERAL SERVICES

J. Gedge & Sons----- 51

## GARAGE/VEHICLE SERVICES

Max Bidwells Vehicle Repair----- 13

Robert Holden SAAB ----- 24

Salhouse Service Centre ----- 25

Howes Motor Services ----- 30

Thorpe End Garage-----40

## GARDENING/LANDSCAPING

Ashleigh Plants-----5

Mower Doctor ----- 13

G. Nicholls, Top Soil ----- 19

Rackheath Paving & Fencing ----- 50

Holmes Garden Services ----- 63

Salhouse Garden Centre ----- 64

Target Trees ----- Back Cover

## HAIRDRESSERS/BEAUTICIANS

Pure Beauty----- Inner Front

The Poppy Room, Pamper Services 29

Rachel Mobile Hairdresser ----- 29

Louise Hair & Beauty-----40

## HEALTH

Foot Health Professional----- 19

Rackheath Pharmacy----- 24

## HOLIDAY ACCOMMODATION

The Old Barn B&B----- 28

Norfolk Hideaways----- Inner Back

## HOME IMPROVEMENTS

Chris Pegg—Carpets ----- 13

Garolla Roller Doors ----- 18

Guy Hubbard - Double Glazing ----- 31

Broadland Flooring----- 52

## KENNELS & PETS

Abbey Pets Crematoria----- 17

Mill Kennels----- 78

## LEISURE/ENTERTAINMENT

Claire Carney, Floral/Balloons ----- 63

## MUSIC TEACHERS/CHOIRS

Carole Tims Piano----- 19

## NEWSPAPER DELIVERIES

Steve McDonald News ----- 37

## PLUMBING & HEATING

Norfolk Woodburners ----- 19

Anglia Gas Services ----- 31

Mower Doctor ----- 13

Bure Valley Woodburners----- 40

Geoff's Plumbing ----- 51

Wroxham Heating J Middleton----- 75

## PROPERTY/MAINTENANCE/ODD JOBS

Handy Andy Odd Job Man----- 13

AAA Pest Control----- 17

Blockbuster Drains ----- 18

Platten Pest Control----- 78

## WINDOW CLEANERS

My Window Cleaners ----- 50

Geordie's Window Cleaning ----- 78

Featured property:  
Indigo Barn

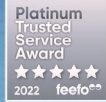

# norfolk hideaways

coastal and country holiday retreats

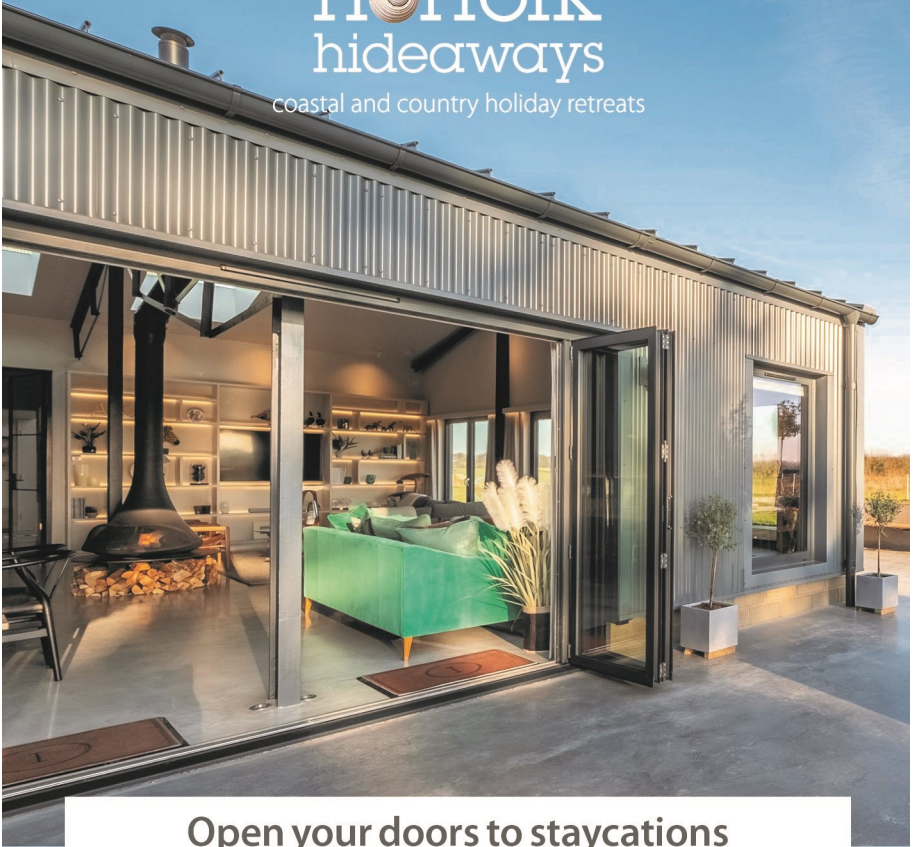

## Open your doors to staycations

At Norfolk Hideaways our local team is well placed to help you let your holiday home

*Benefits include:* A Marketing or Marketing and Managed service  
Professional photography | No joining or annual fee | Peace-of-mind damage cover  
Competitive commission rate | No restrictions on the use of your property

*Why not get in touch today and request your FREE Property Letting Guide?*

[norfolkhideaways.co.uk](https://norfolkhideaways.co.uk) | 01328 887 658  
Offices in Holt, Burnham Market and Wells-next-the-Sea





# Target Trees™

PROFESSIONAL TREE MANAGEMENT  
AND CONSULTANCY

All aspects of tree surgery, site management and consultancy services offered by a fully qualified, experienced & insured team.



Phone: 01603 916154 Email: [info@targettrees.com](mailto:info@targettrees.com)

Website: [www.targettrees.com](http://www.targettrees.com)